

INITIUM™

2 in 1 Cockpit Manual

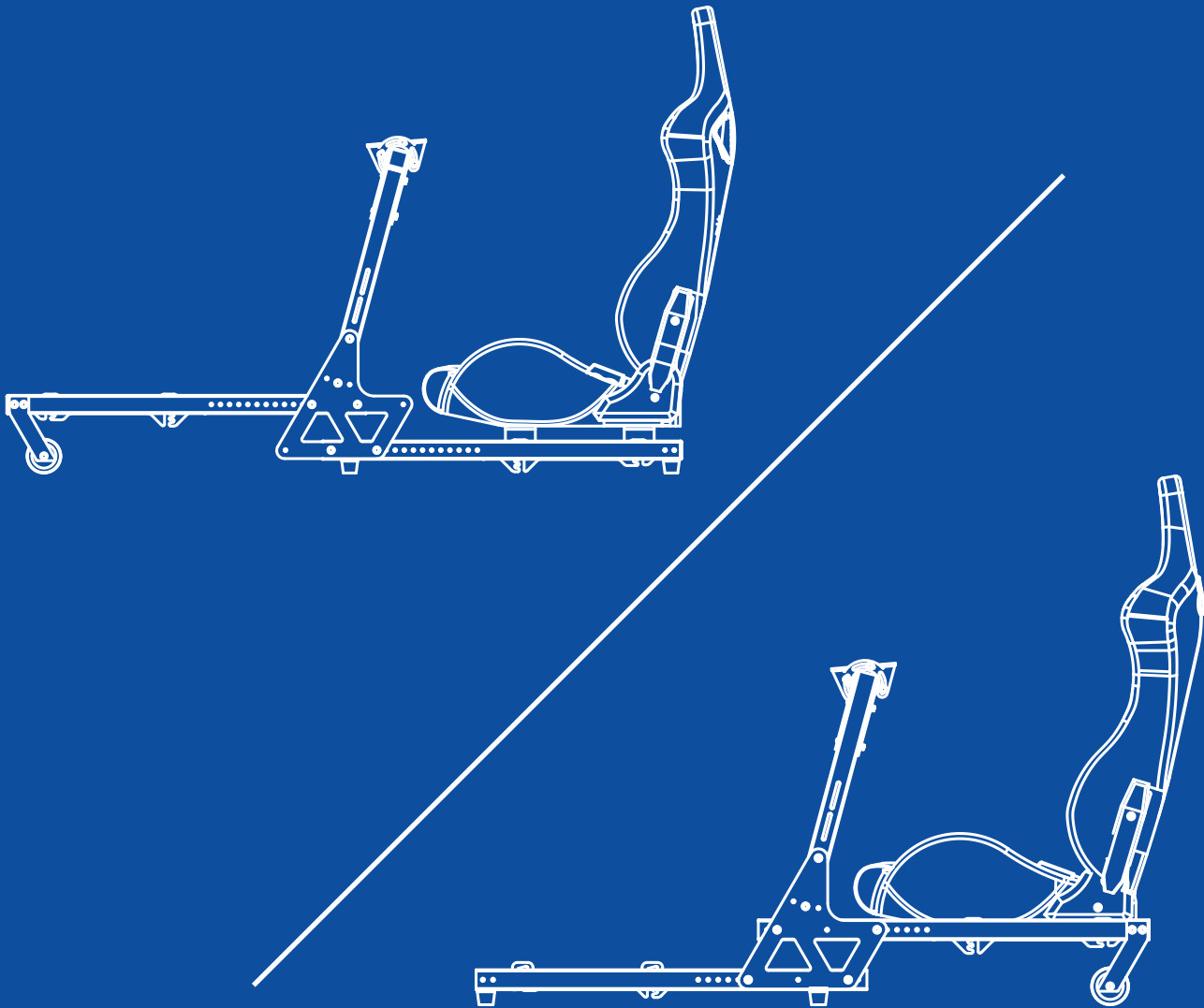

ASETEK RACING™

Table of contents

- Foreword 3
 - About This Document 3
 - Copyright 3
- 1. Introduction 4
 - 1.1 Box Contents 4
 - 1.2 Videos 5
 - 1.3 Manual version 5
 - 1.4 Support & Contact 5
- 2. Product..... 5
 - 2.1 Warranty 5
 - 2.2 Warnings and guidelines for safe assembly and usage 5
- 3. Getting Started 6
 - 3.1 Assembly instructions 6
- 3. GT Configuration 7
- 3. Formula Configuration 23
- 4. Troubleshooting 39
- 5. De-commissioning & Sustainability 39
 - 5.1 Packaging 39
 - 5.2 Product 39

Foreword

About This Document

This manual is written for the end-user of the Asetek Racing™ Initium™ 2 in 1 Cockpit (hereon after: “cockpit”) and contains all information required to correctly and safely install, use, and maintain the following models:

Model Name	C-S-1
Product Name	Initium 2 in 1 Cockpit
Product Code	40-060-0060001

This manual was authored in English. All other languages are translations of the original document. Please make sure that you have thoroughly read and understood all contents of this manual before installing or using the wheelbase.

Asetek Denmark A/S Skjoldet 20 9230 Svenstrup J Denmark www.asetek.com	
--	---

Copyright

The content of this manual is protected by copyright and other international intellectual property laws. The contents of this manual or any parts thereof may only be made public, copied, modified, reproduced, translated with express written permission from Asetek.

This manual or any parts thereof may only be published, transmitted, displayed, or made available to a third party with express written permission from Asetek SimSports®.

1. Introduction

1.1 Box Contents

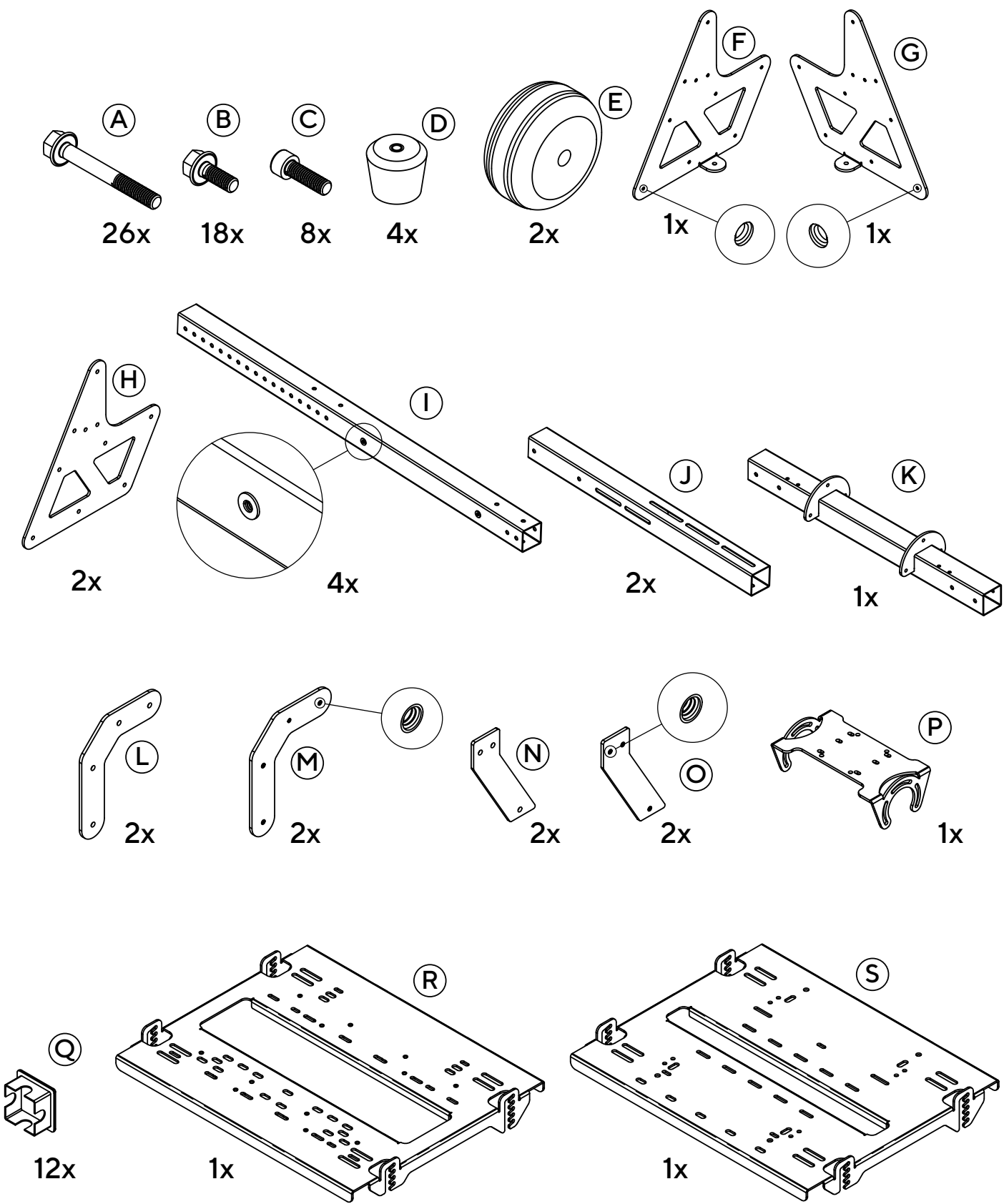

1.2 Videos

On the Asetek SimSports® YouTube channel, you can find tutorial videos that demonstrate numerous ways to set up and use your equipment.

<https://www.youtube.com/aseteksimsports>



1.3 Manual version

This manual is version 1.0.

You will always be able to find the latest version of the manual at:

www.asetek.com/simsports/knowledge-base/



1.4 Support & Contact

Should you stumble upon further questions that are not covered in this manual or any of our detailed instruction videos, we encourage you to contact our friendly support staff at

<https://www.asetek.com/simsports/support/>



2. Product

2.1 Warranty

Asetek SimSports® offers 24 Months warranty on all products.

2.2 Warnings and guidelines for safe assembly and usage

- WARNING: Choking Hazard – Small parts. Not for children under 3 years.
- Some of the parts are heavy; proceed with caution.
- Do not use power tools to assemble the rig to avoid damaging the parts or overtightening the screws.
- Due to the nature of steel, some metal shavings may remain even after quality assurance. We advise you to unpack the boxes on a hard floor and inspect the product before assembly. In case metal shavings are present, use protective gloves and safety glasses during removal. We recommend using a vacuum or damp cloth to collect and dispose of the shavings.
- Assembly of the rig is allowed only by an instructed person who understands and follows the above safety instructions.
- If the Rig becomes damaged in any way, stop using it immediately and contact Asetek support or the reseller from whom you bought it.
- Operating environment:
 - 0°C – 40°C room temperature, non-condensing humidity
 - Indoor use only



3. Getting Started

3.1 Assembly instructions

When first assembling you Initium 2 in 1 cockpit, you'll have the option of choosing between a GT and a Formula configuration.

GT Configuration - page 7

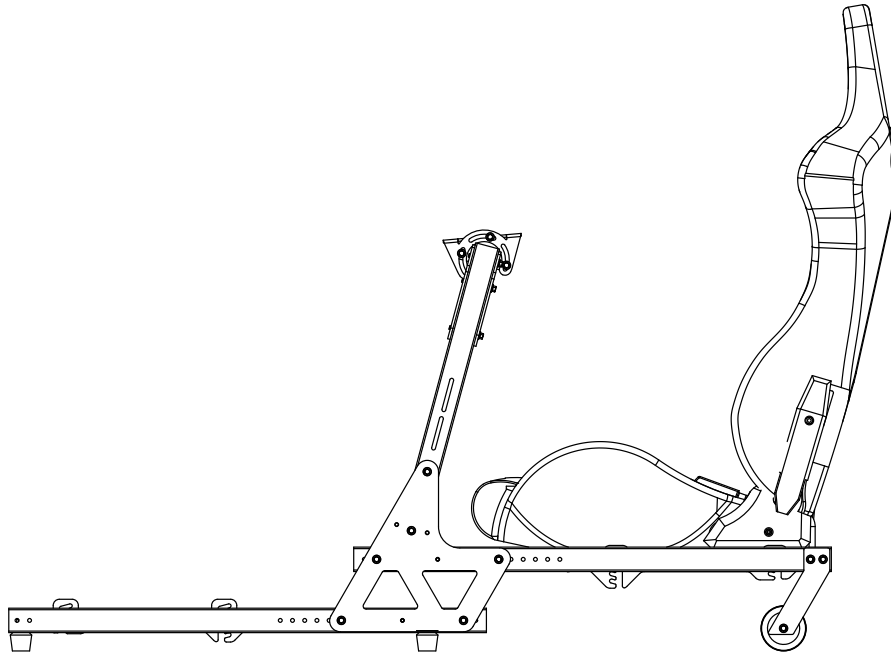

Formula Configuration - page 23

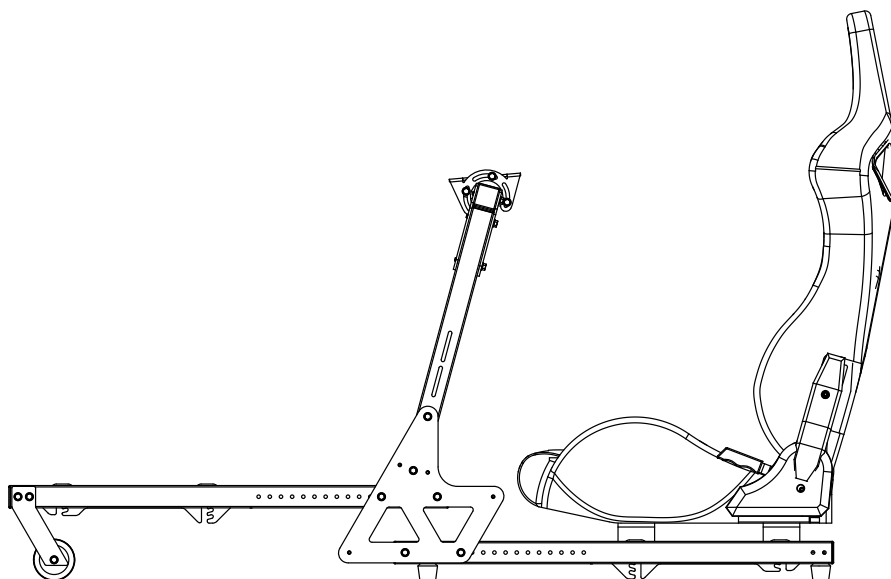

3. GT Configuration

1.

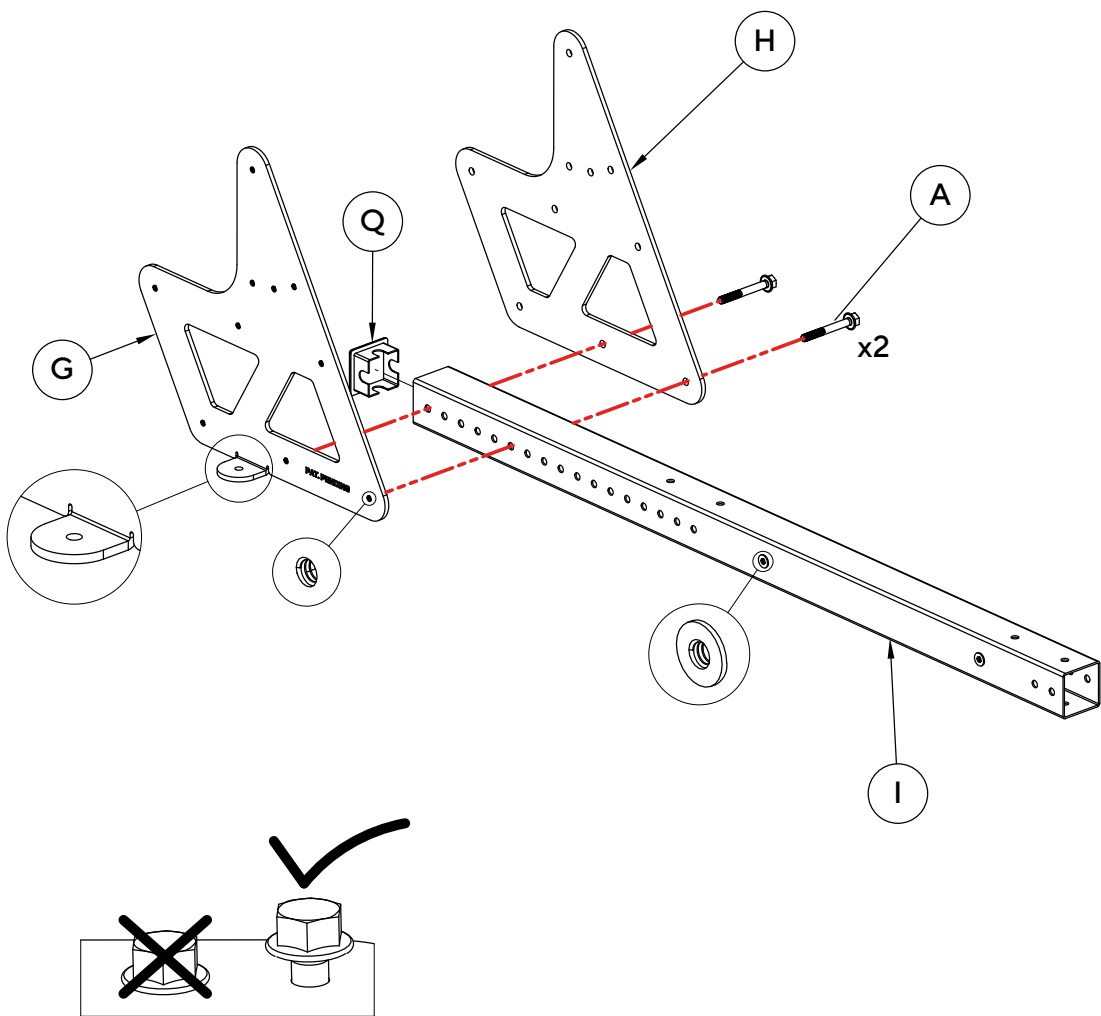
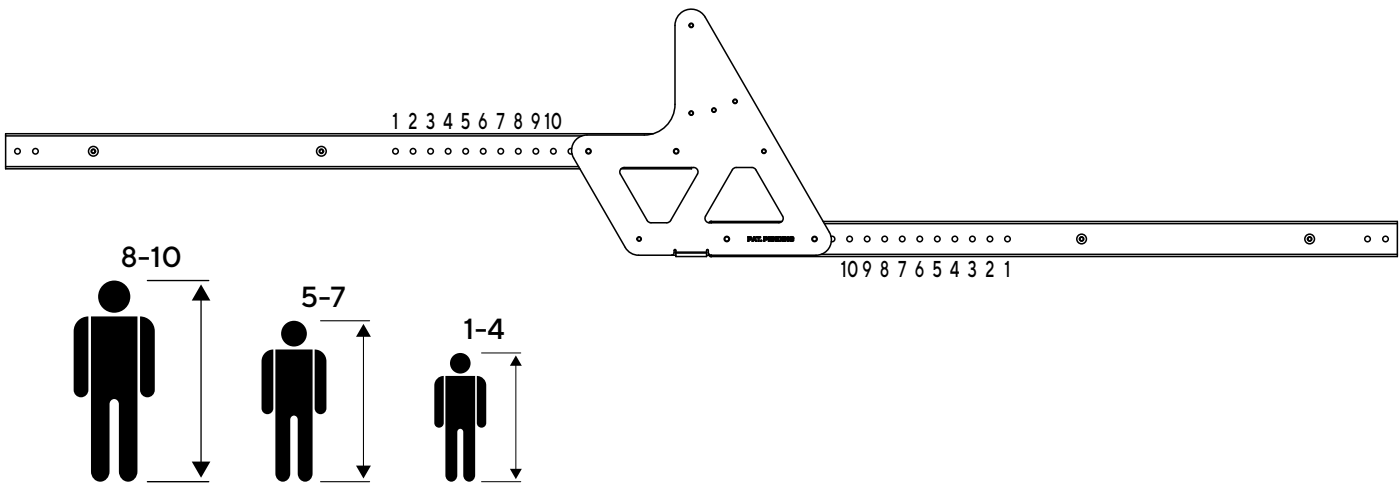

2.

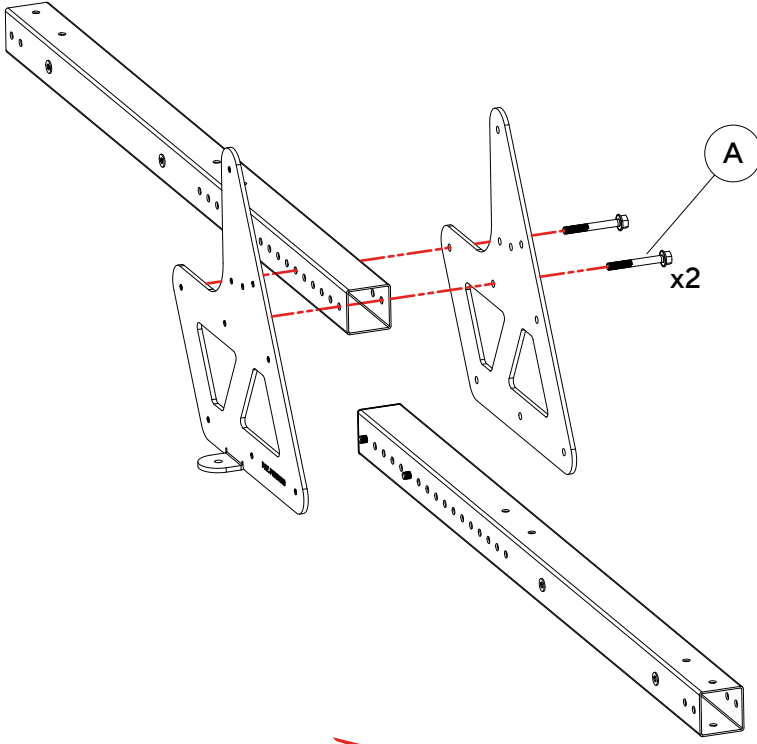
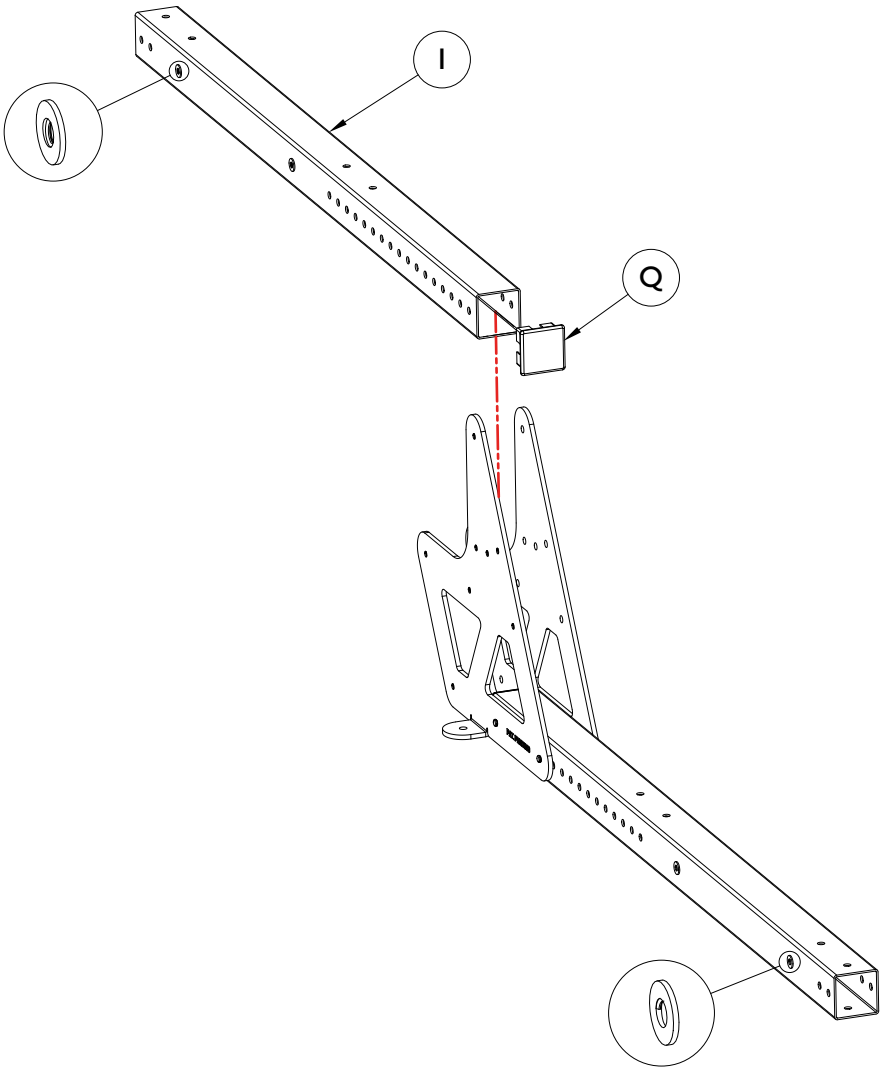

3.

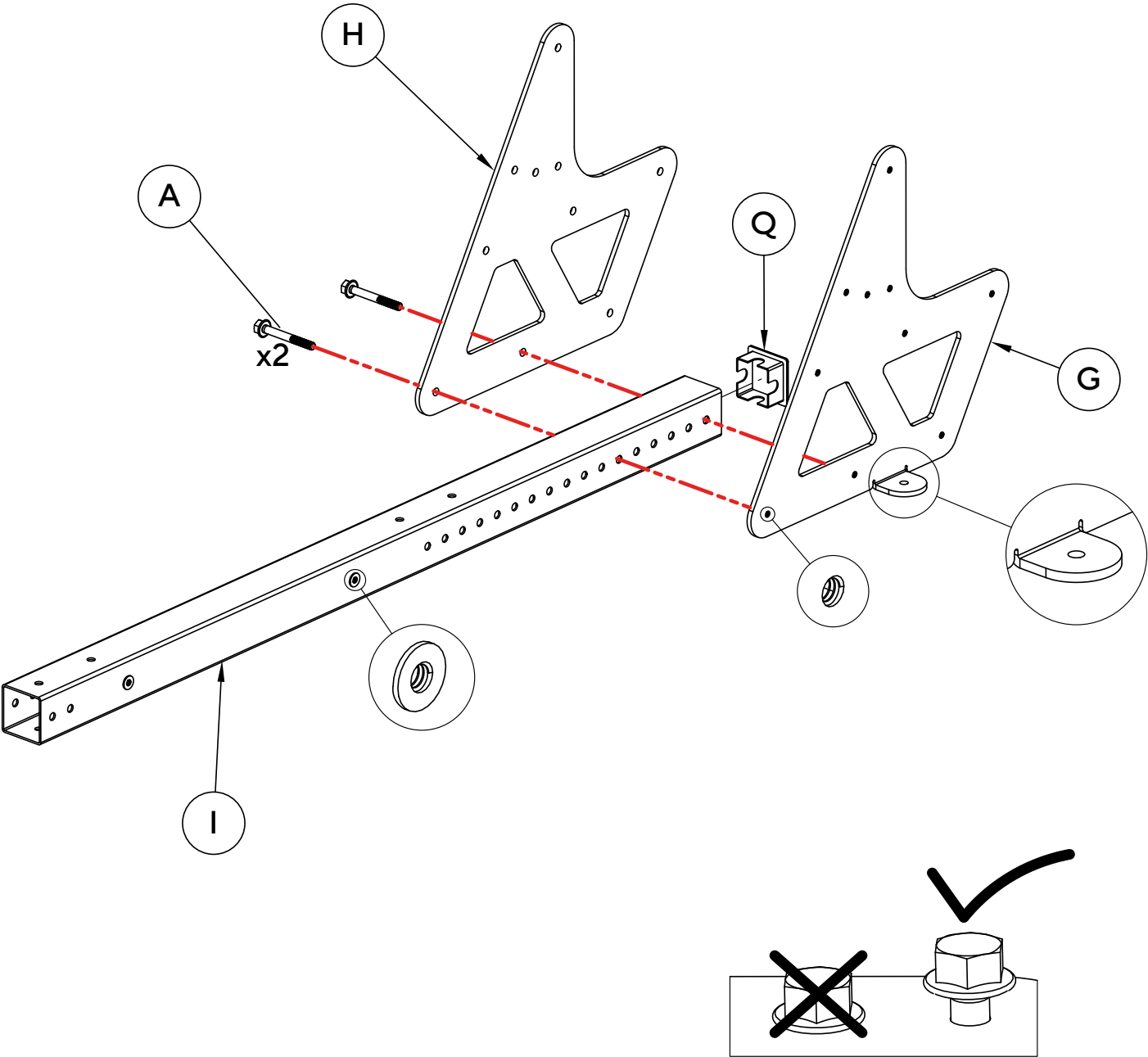

4.

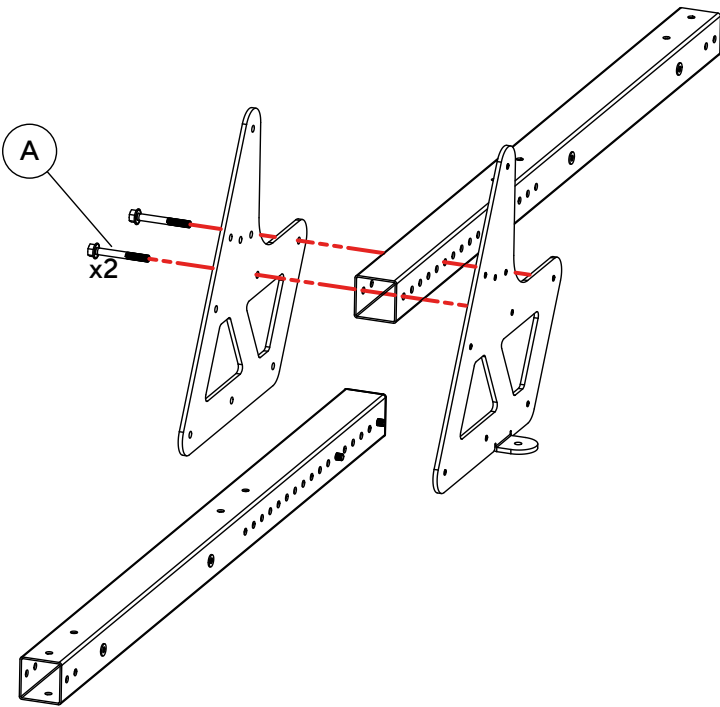
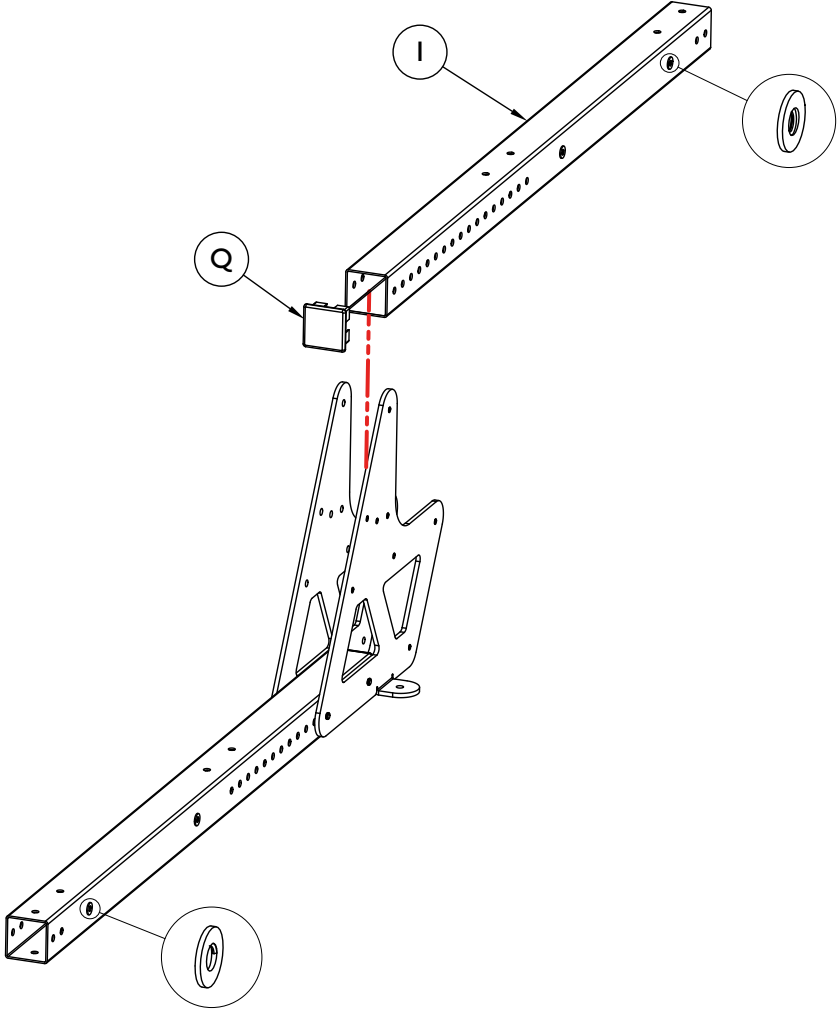

5.

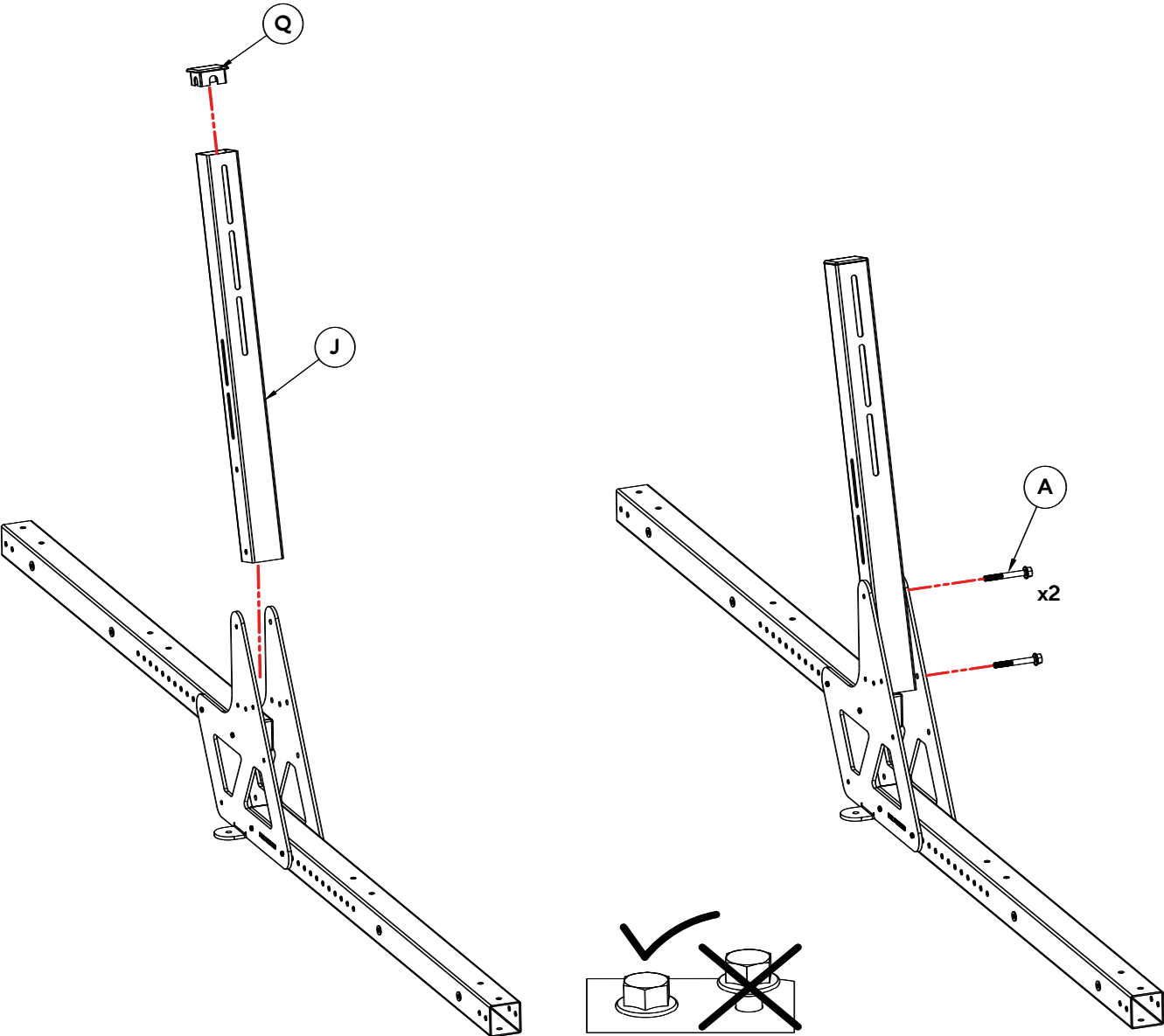
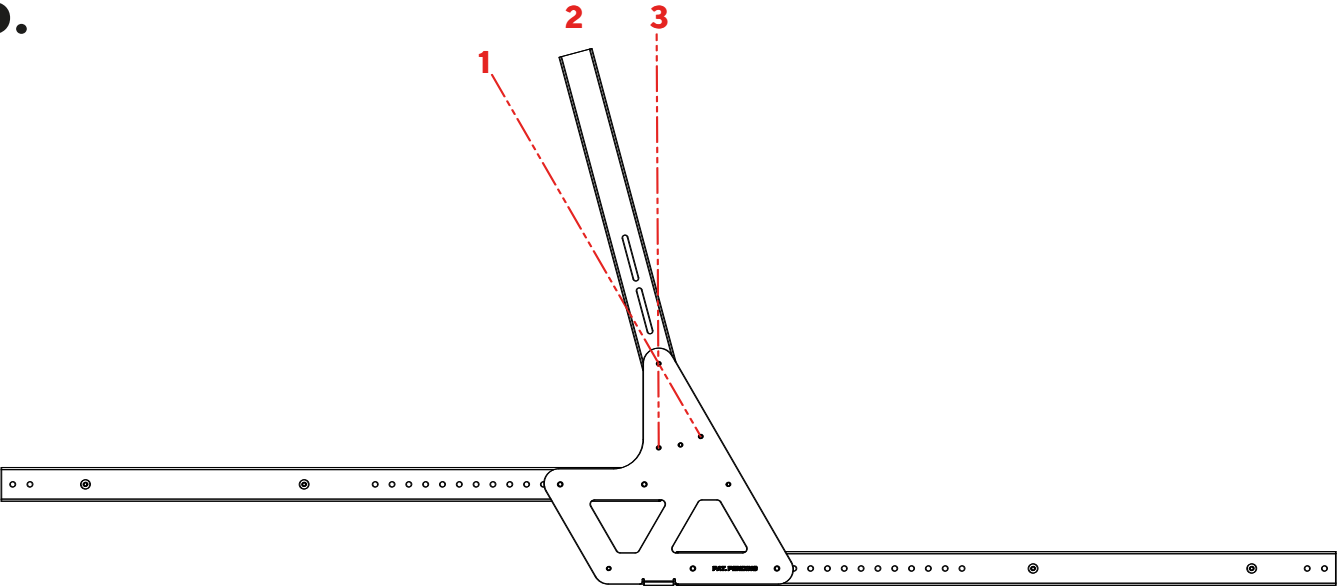

6.

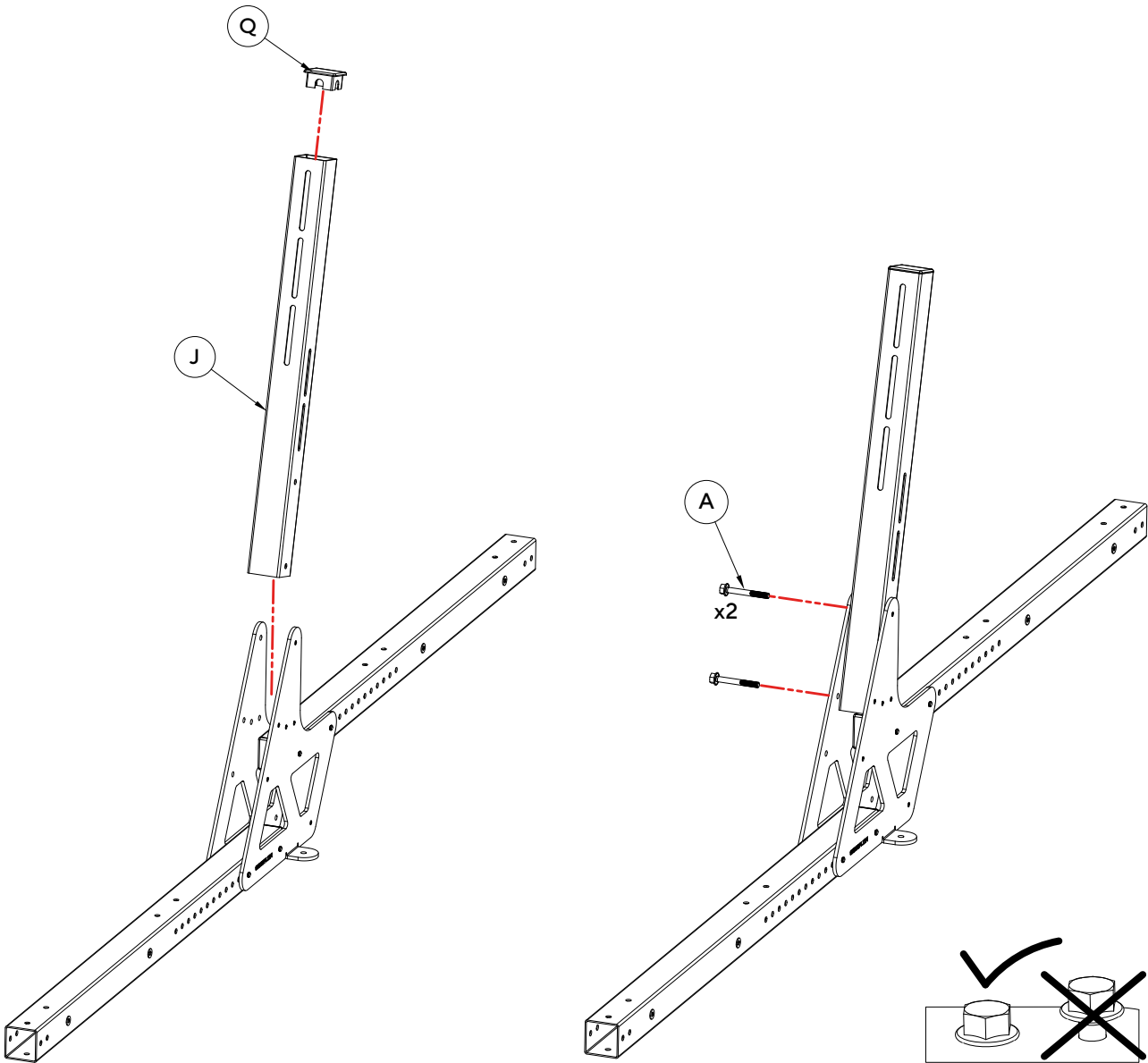
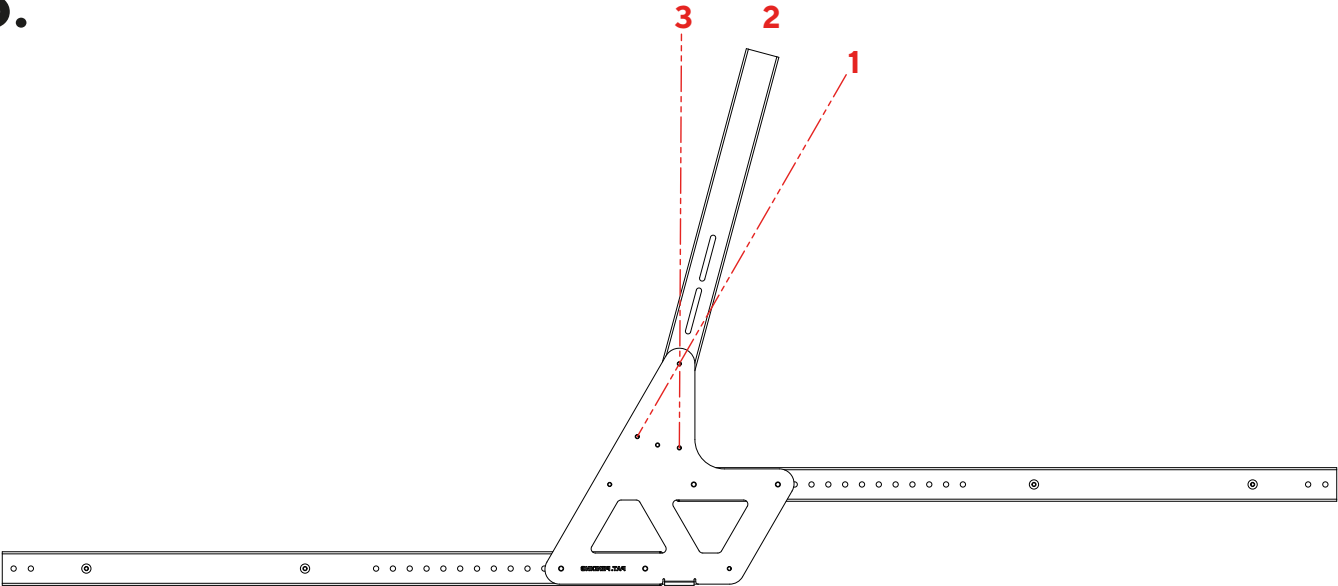

7.

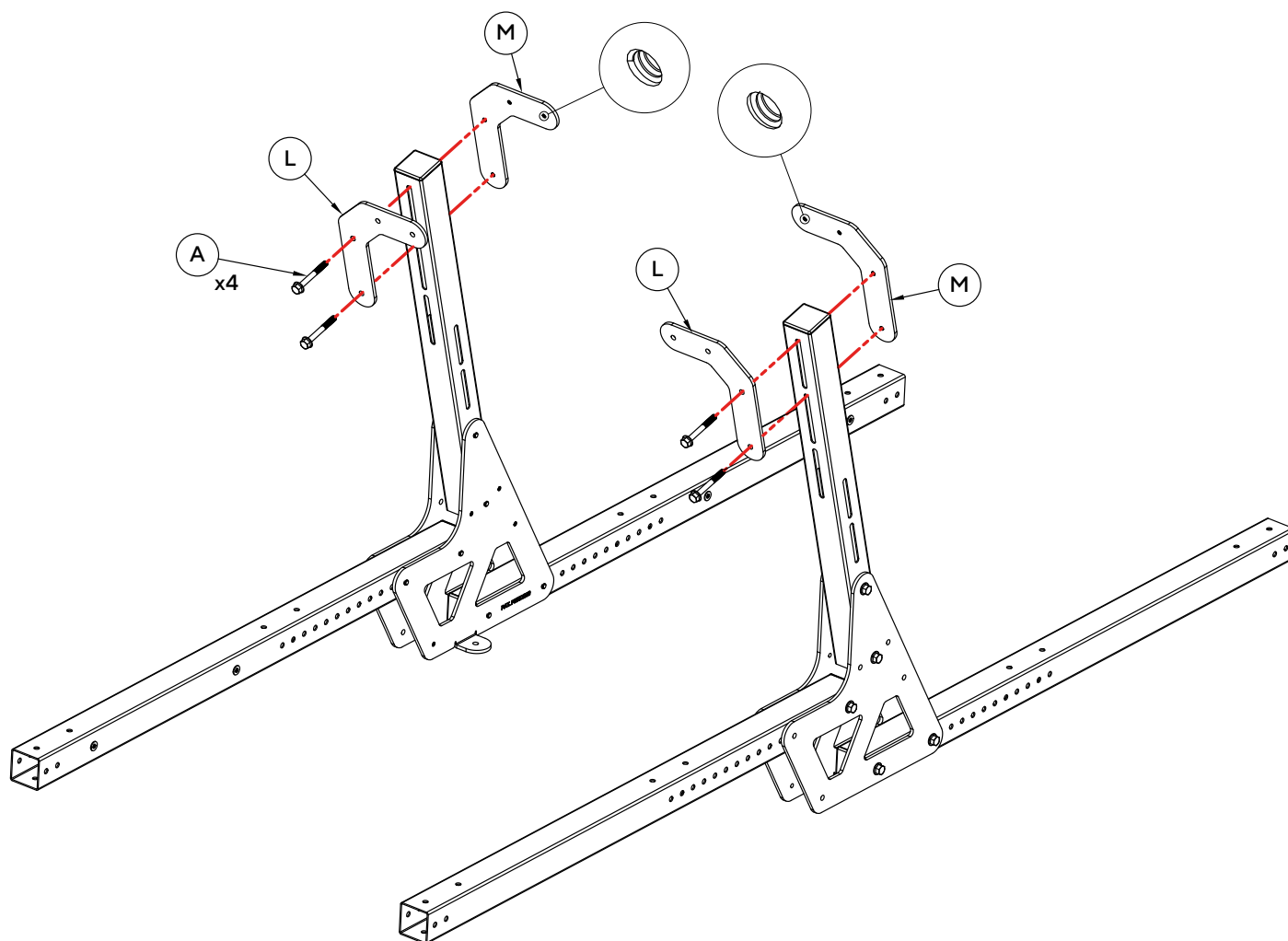

8.

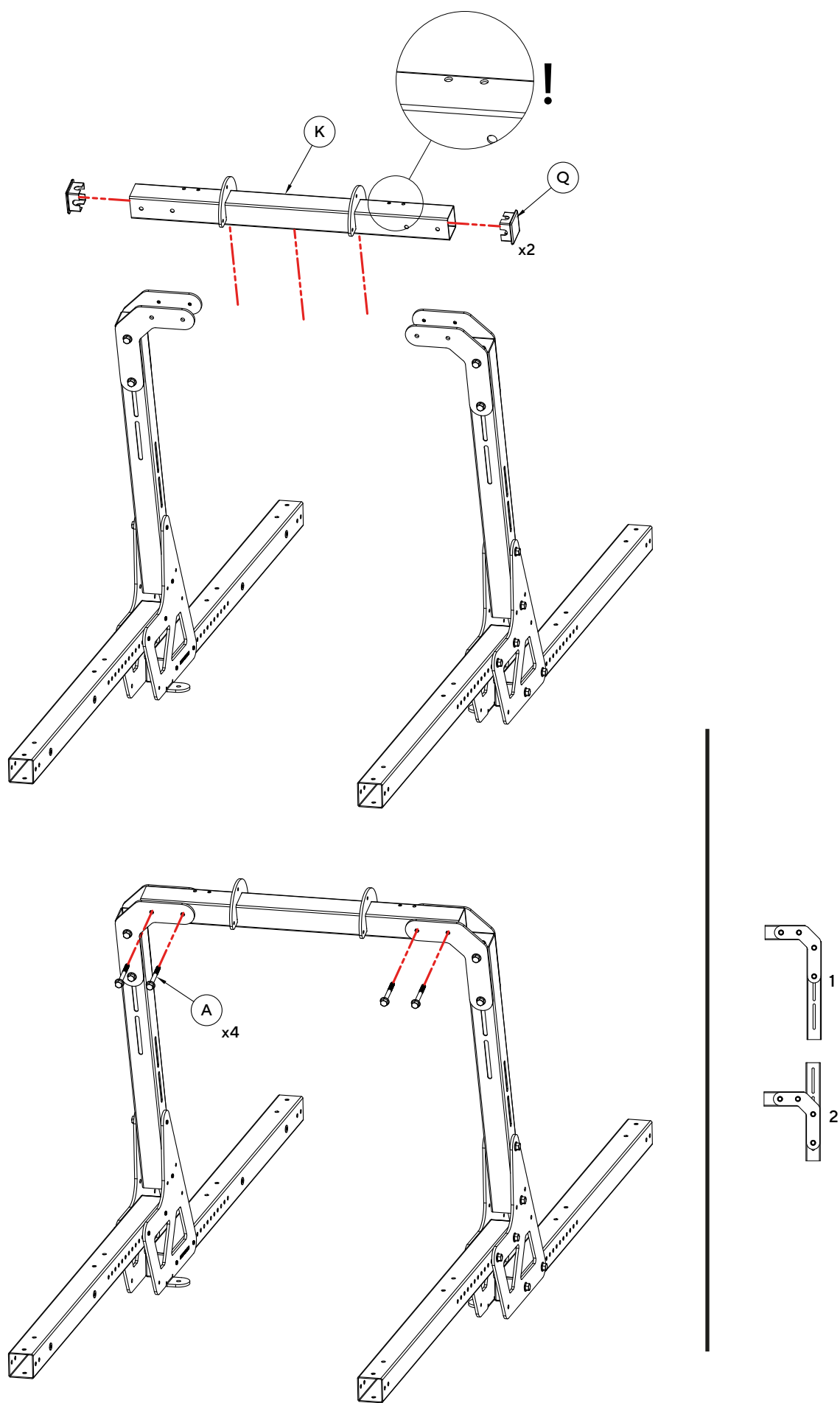

9.

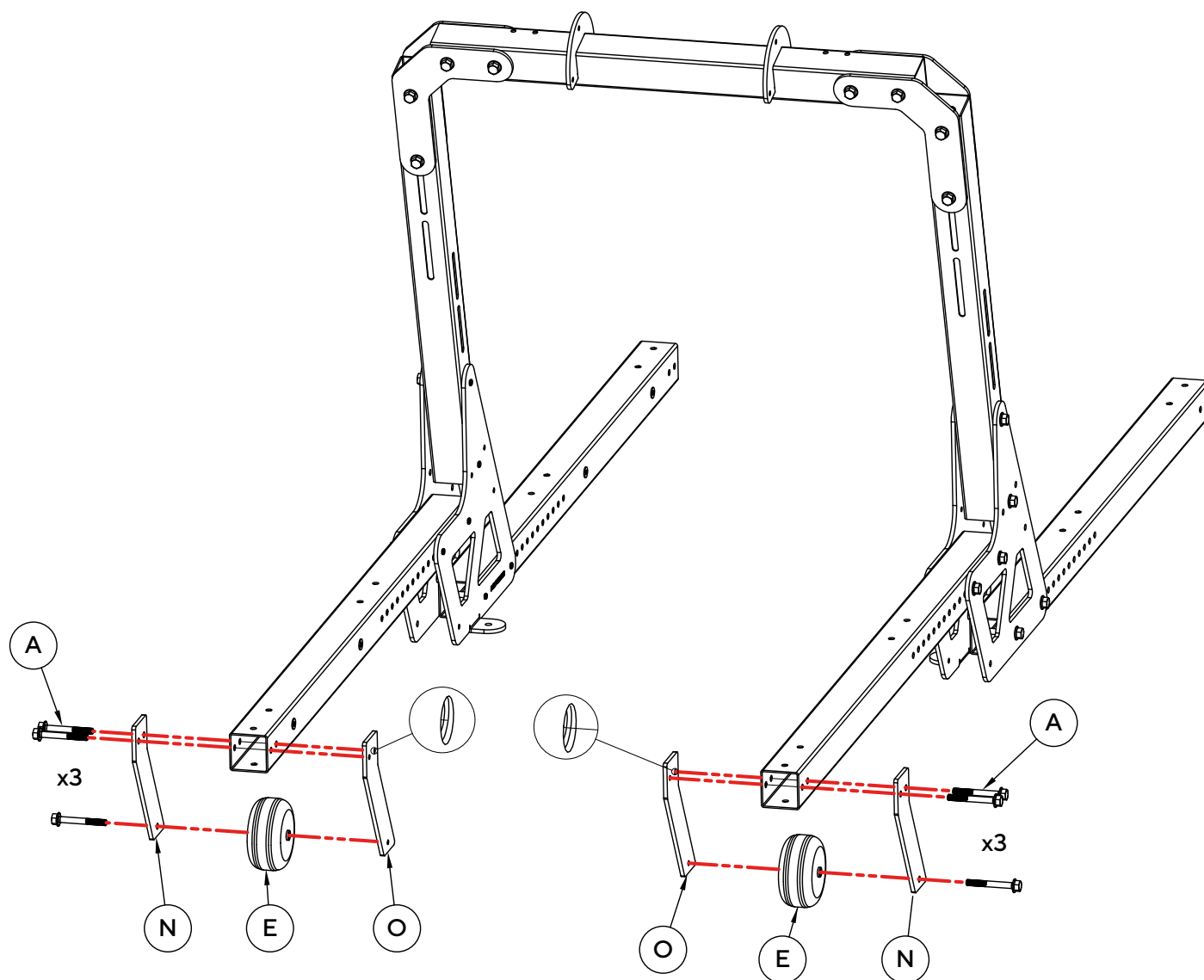

10.

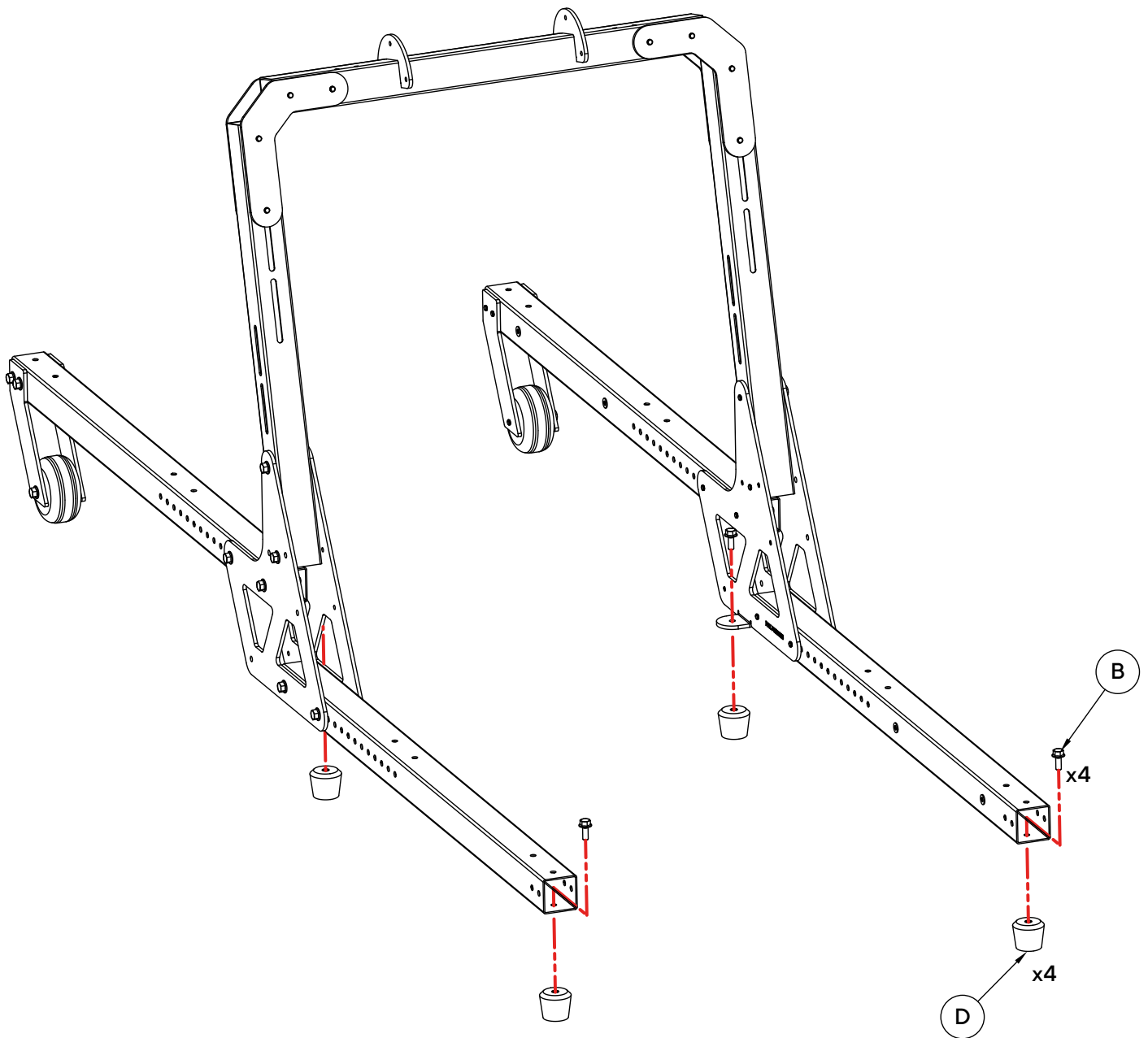

11.

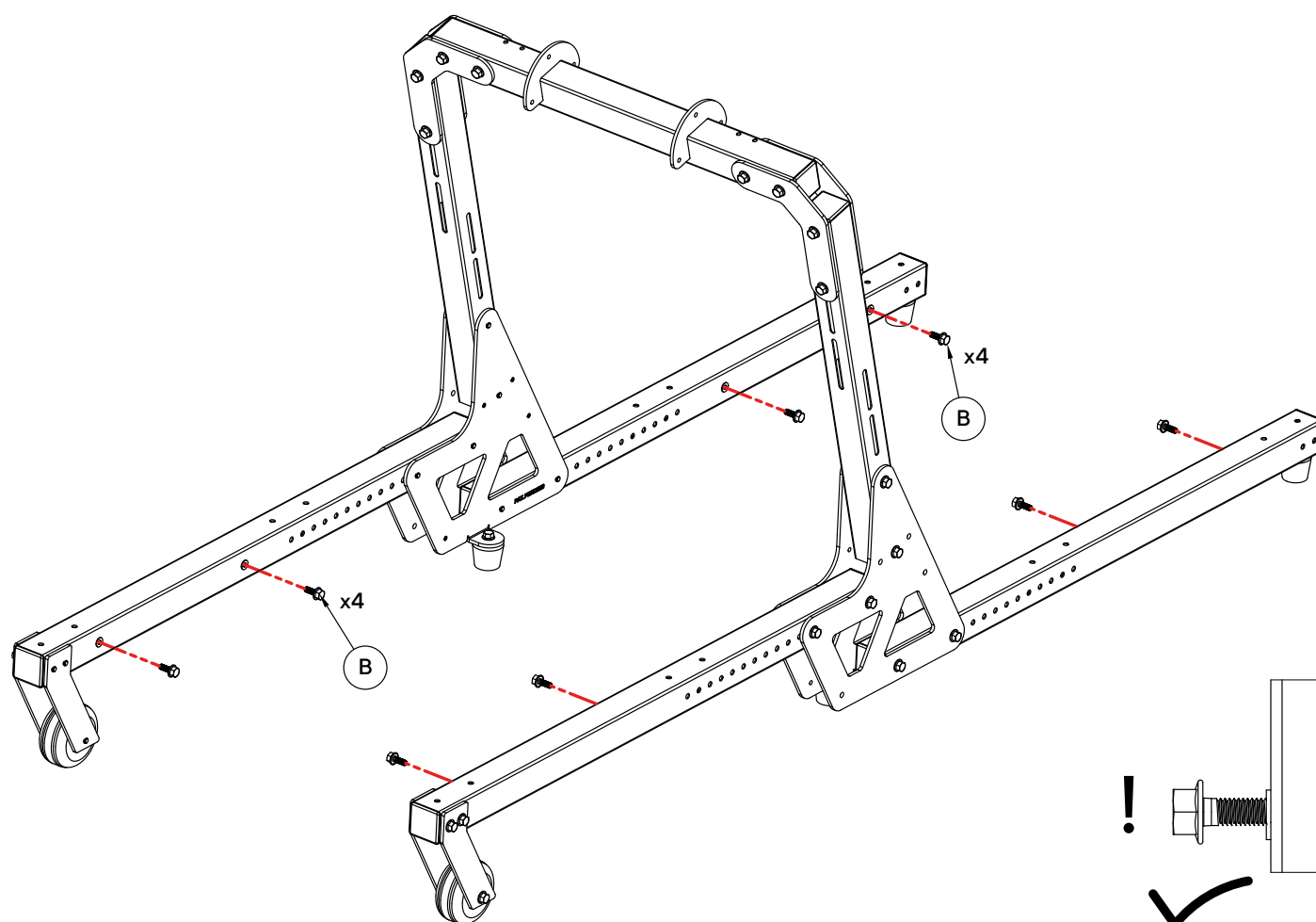

12. Pedal and seat compatibility

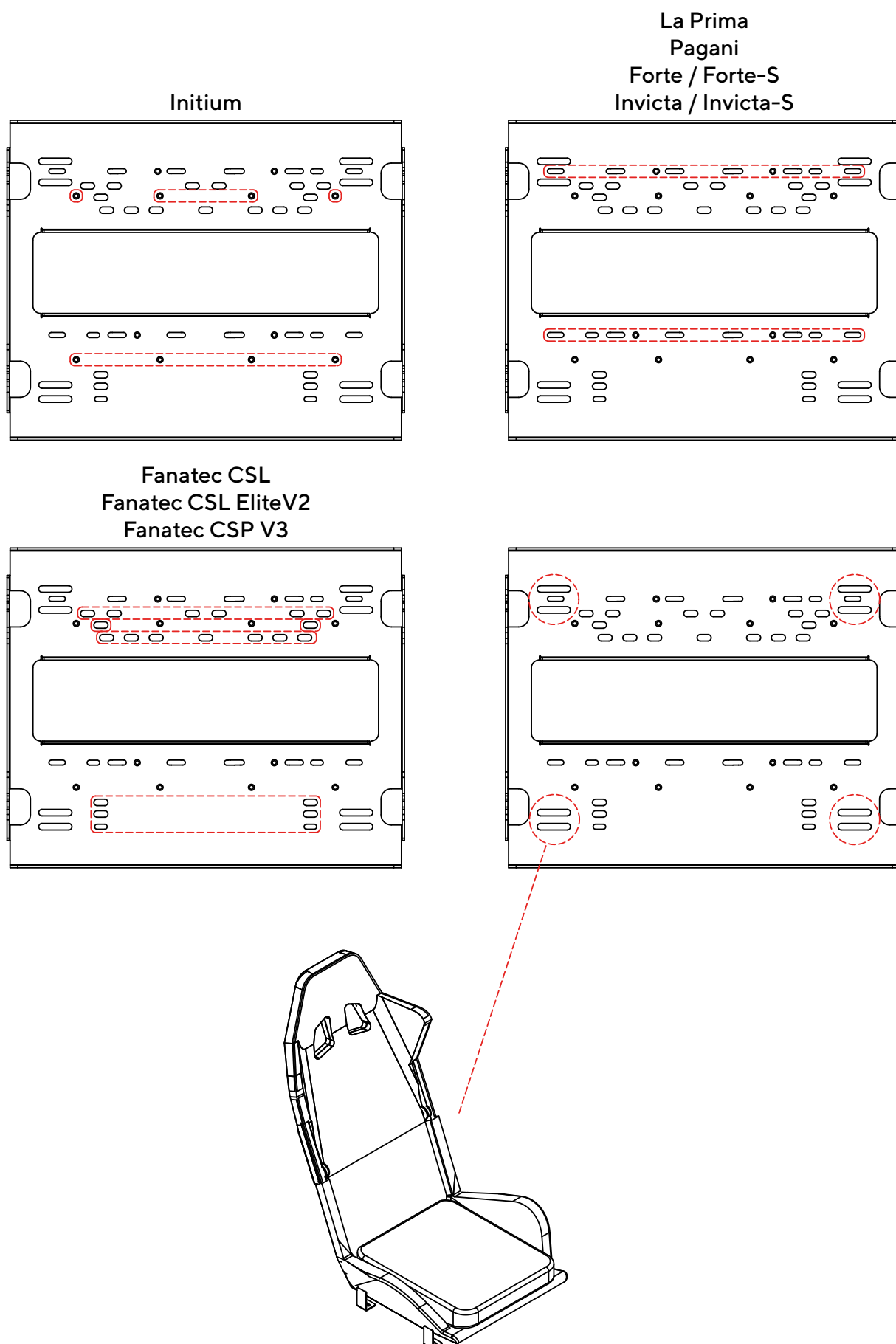

Moza CRP
Moza SRP

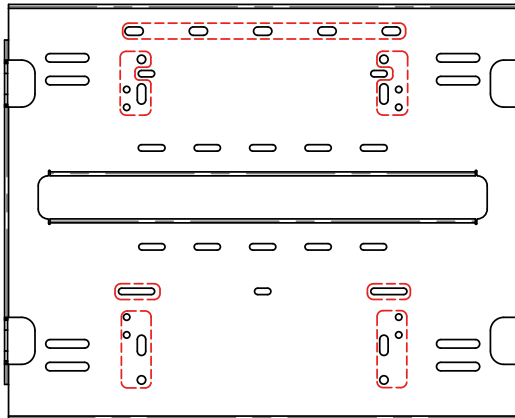

Thrustmaster T-LCM
Thrustmaster T3PA
Thrustmaster T3PM

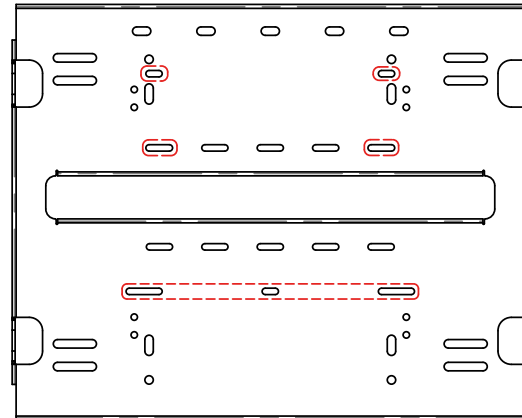

Logitech G Pro Racing

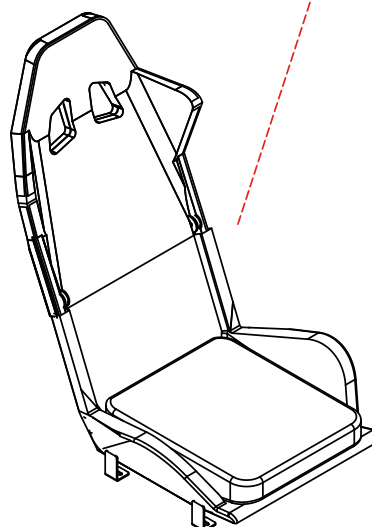
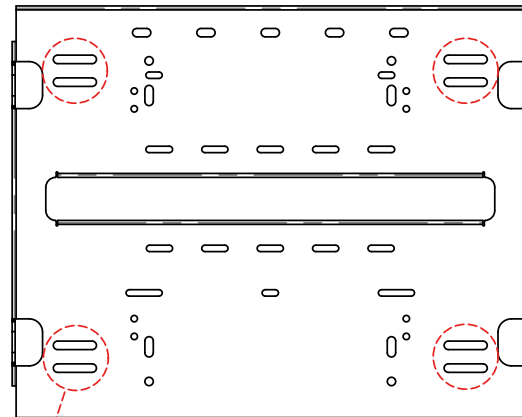
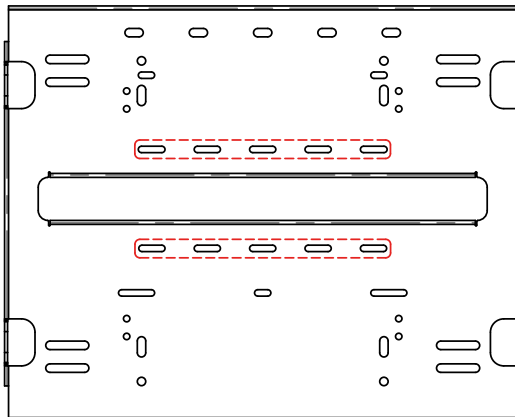

13.

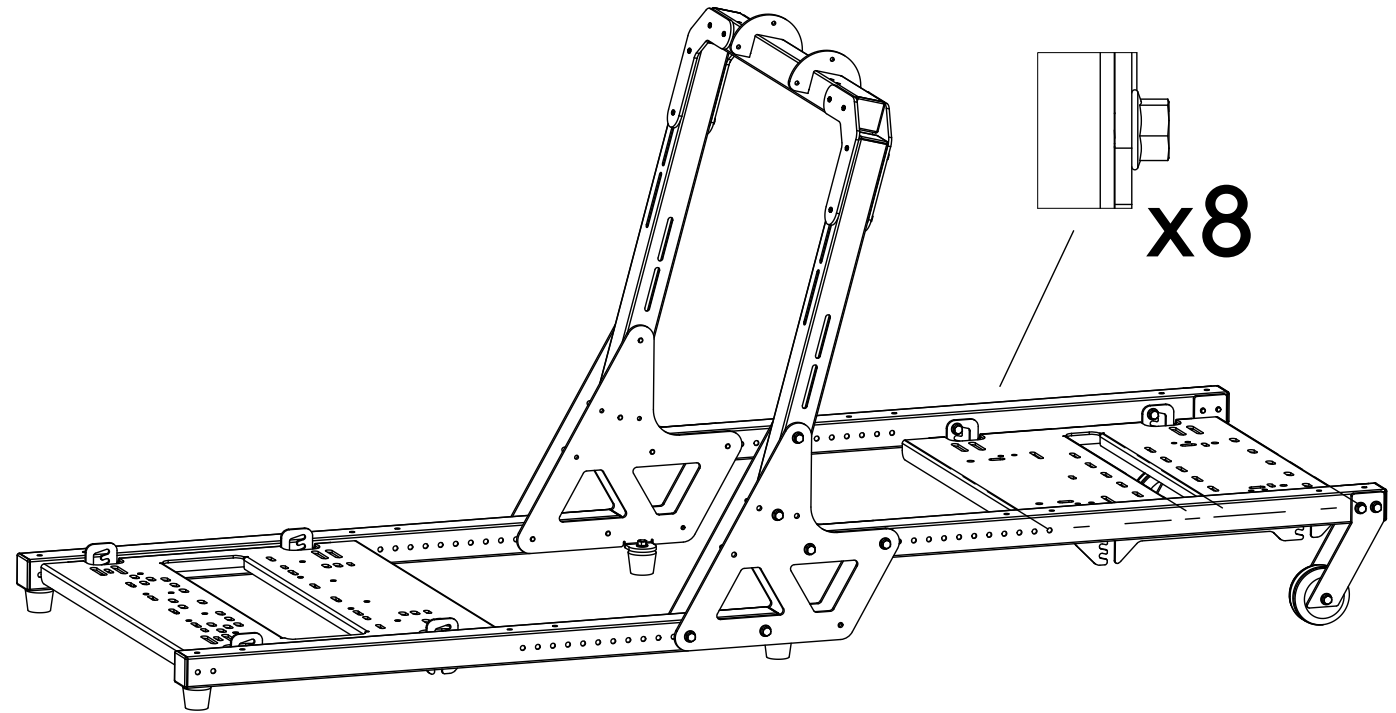
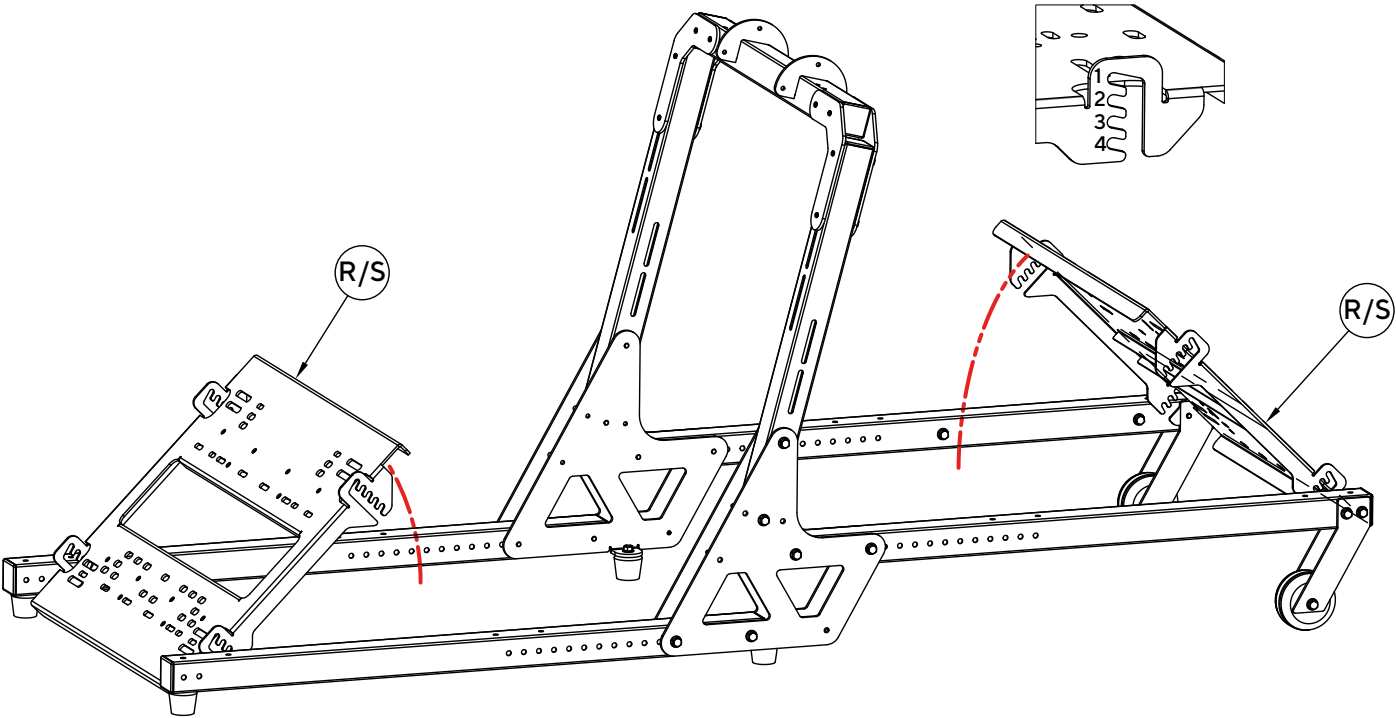

14.

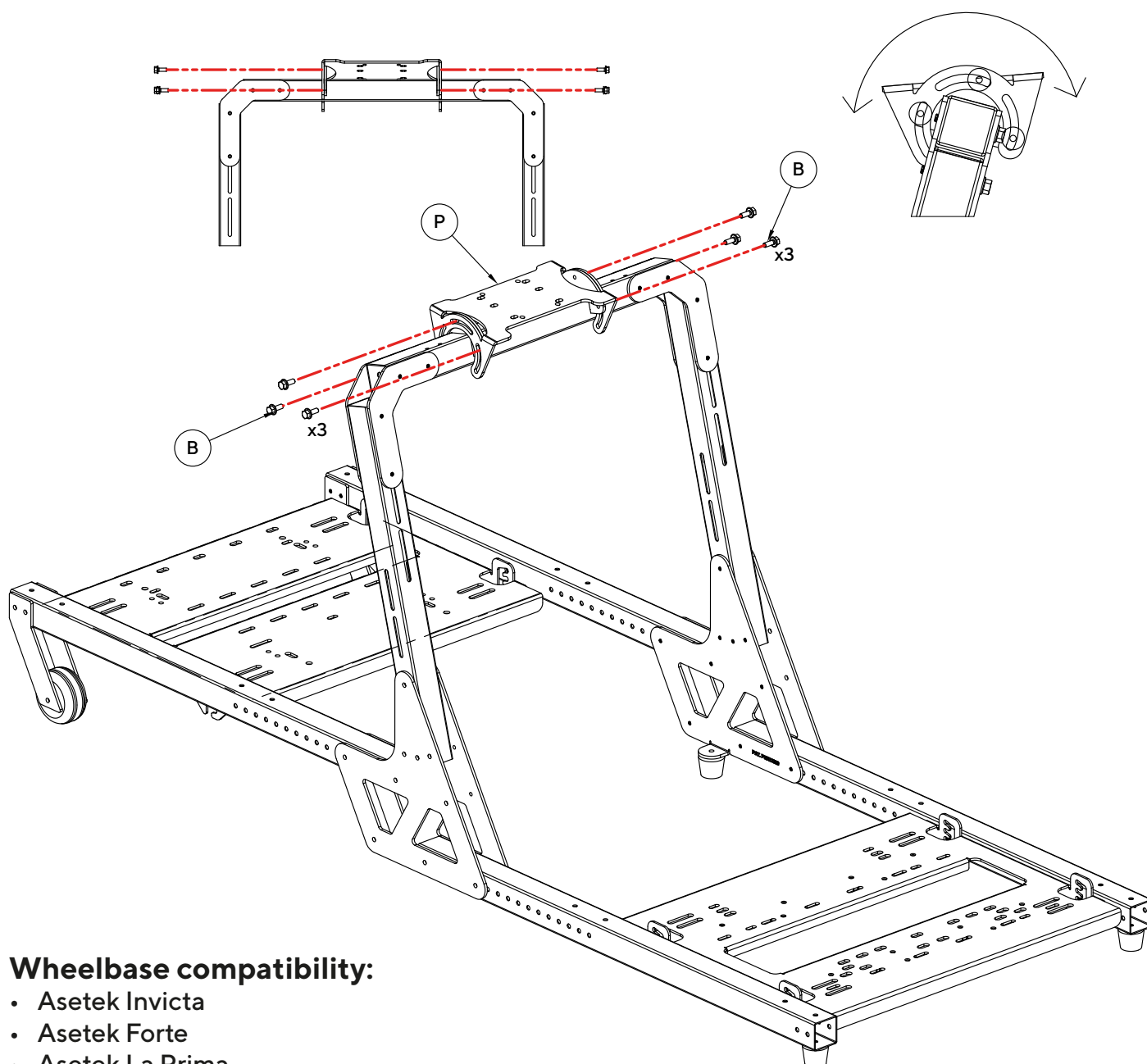

Wheelbase compatibility:

- Asetek Invicta
- Asetek Forte
- Asetek La Prima
- Asetek Initium
- Fanatec Podium DD1/DD2
- Fanatec Clubsport DD
- Fanatec Clubsport DD+
- Fanatec Clubsport DD Pro
- Fanatec CSL DD
- Thrustmaster T818
- Moza R3
- Moza R5
- Moza R9
- Moza R12
- Moza R16
- Moza R21

15.

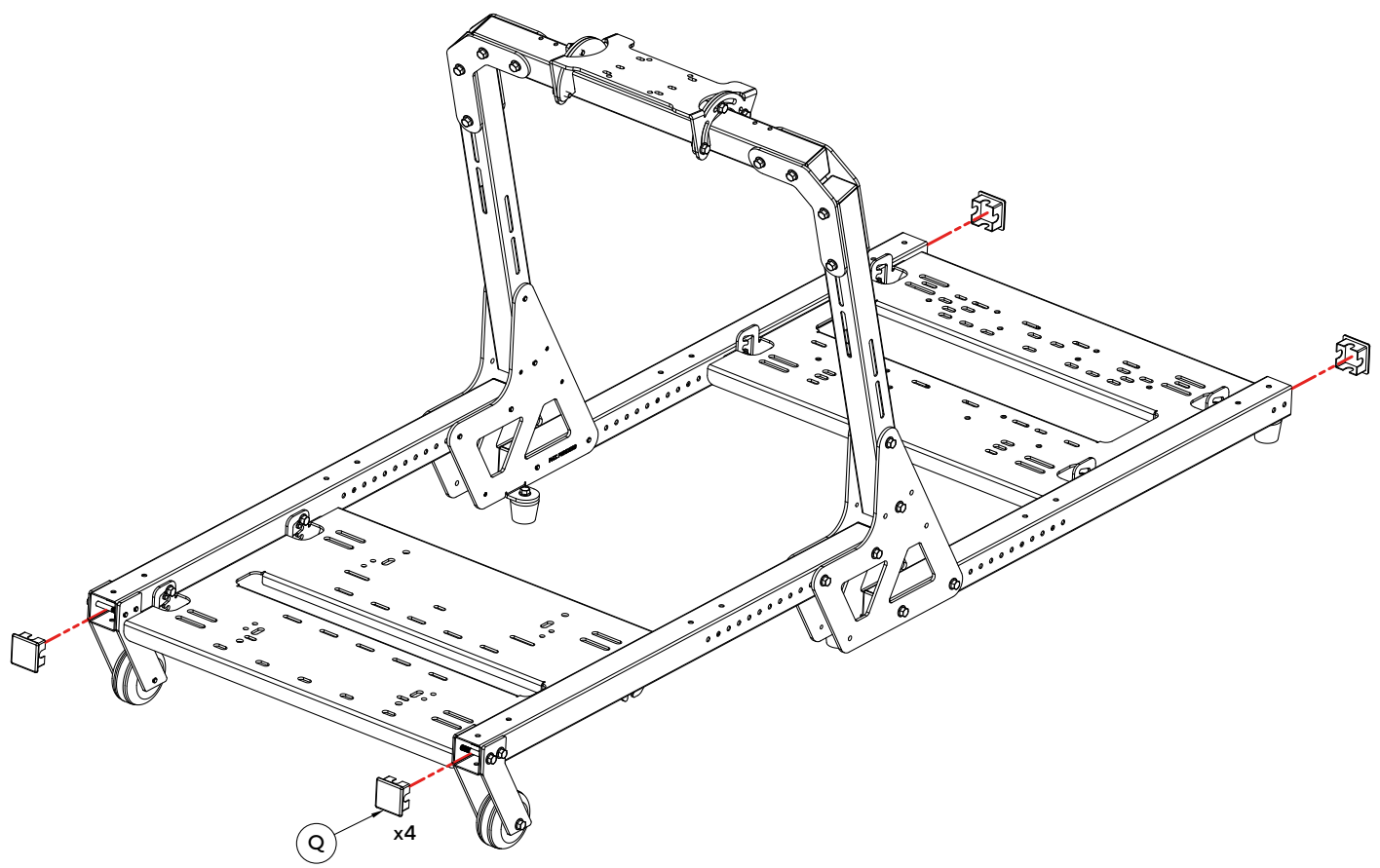

3. Formula Configuration

1.

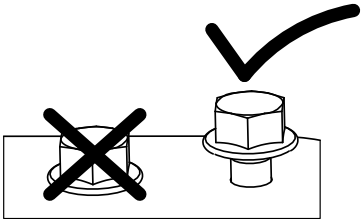
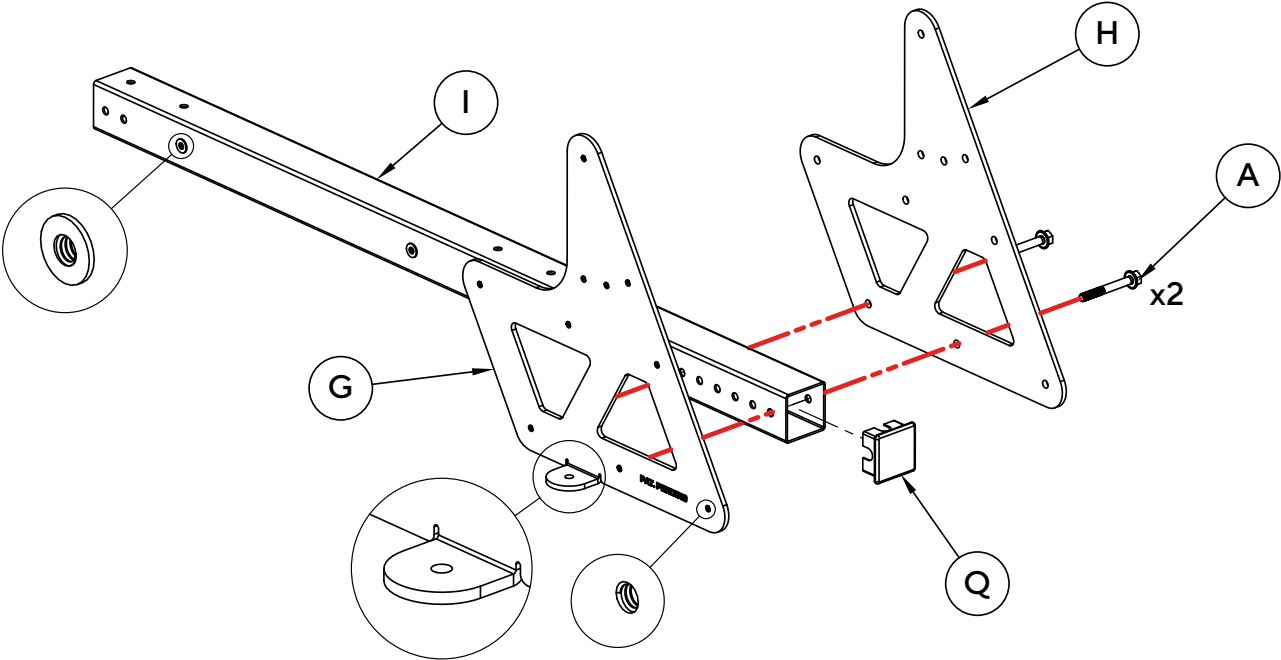
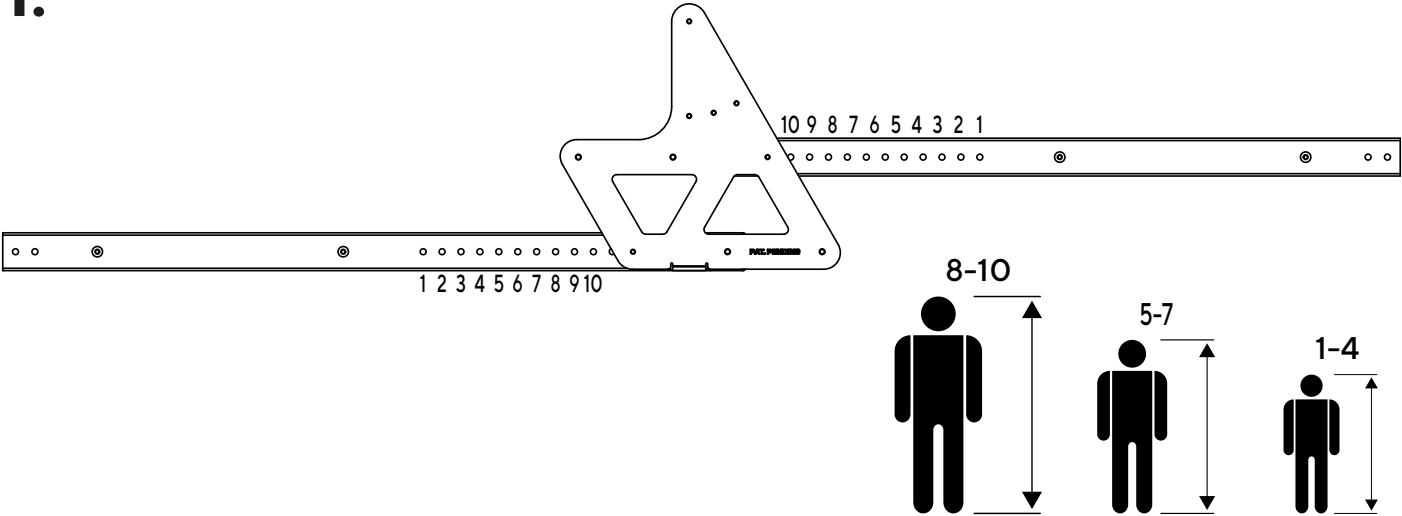

2.

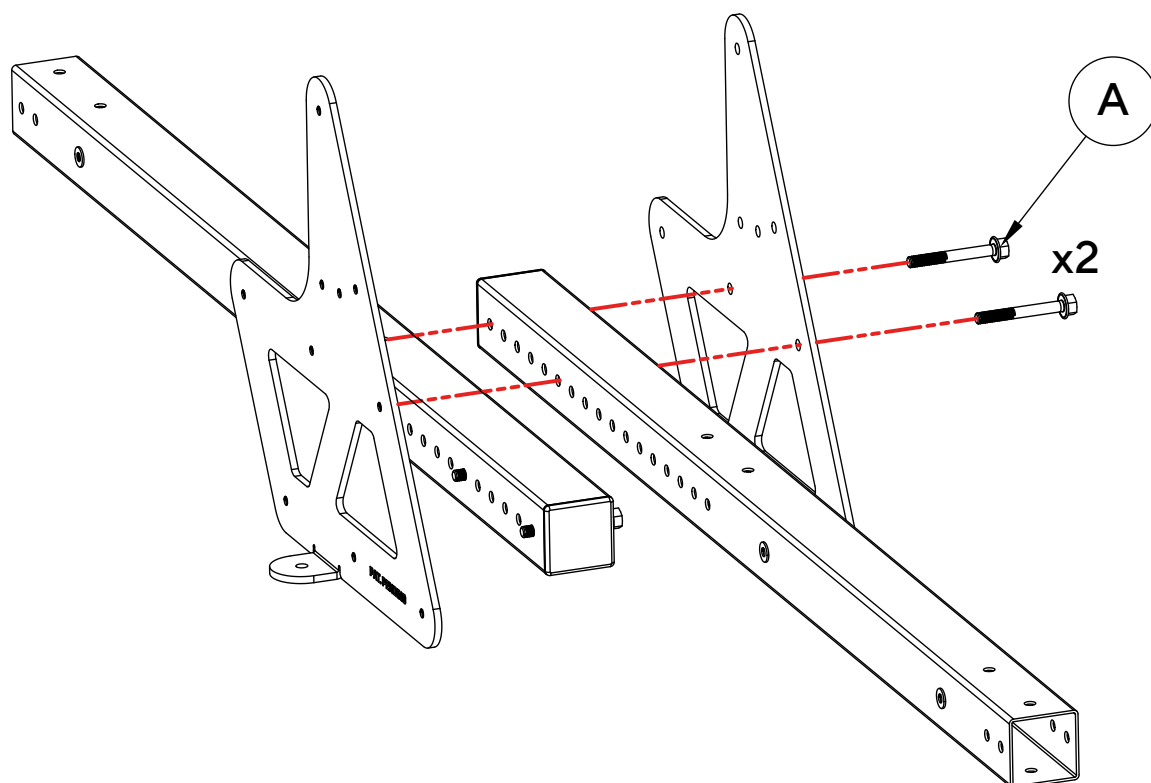
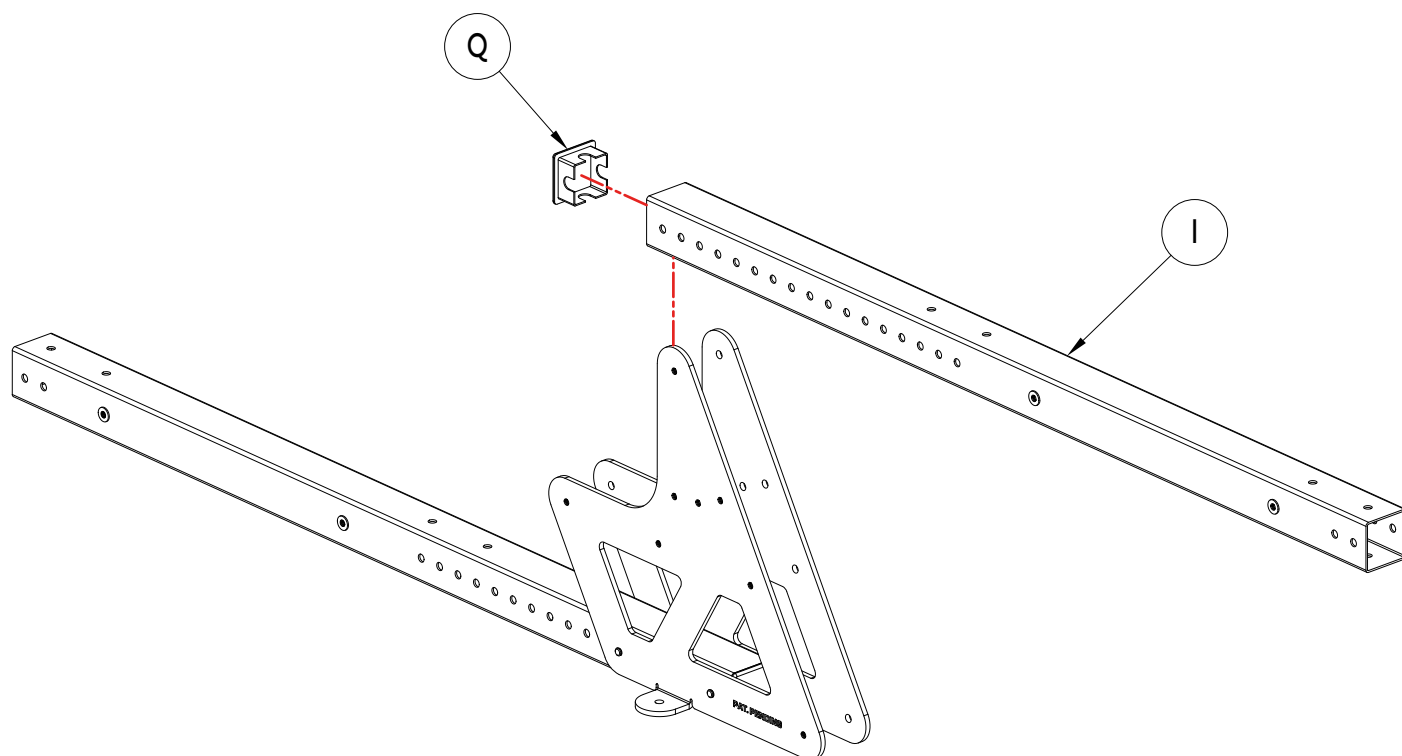

3.

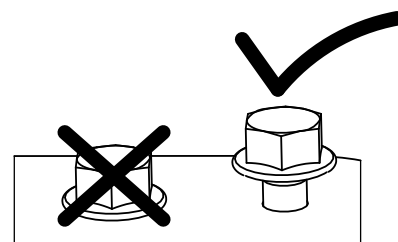
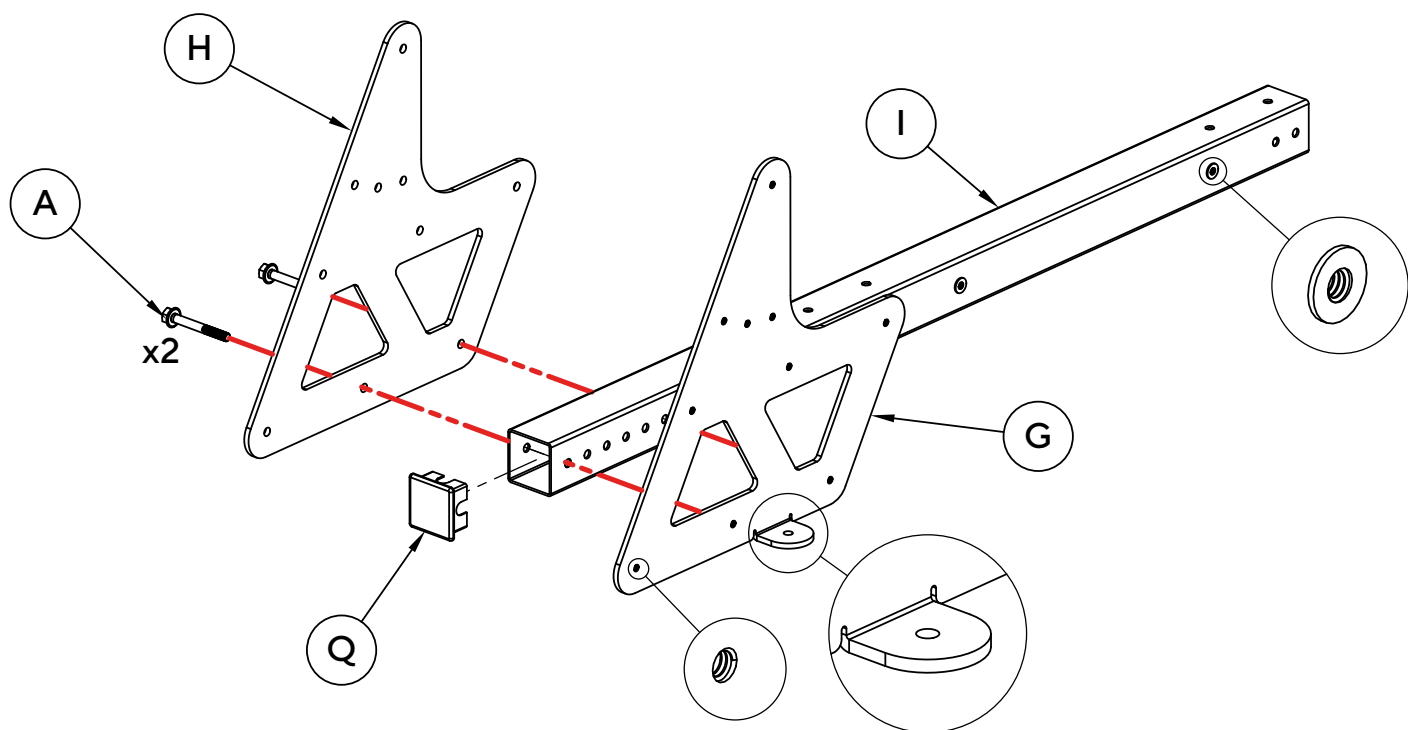

4.

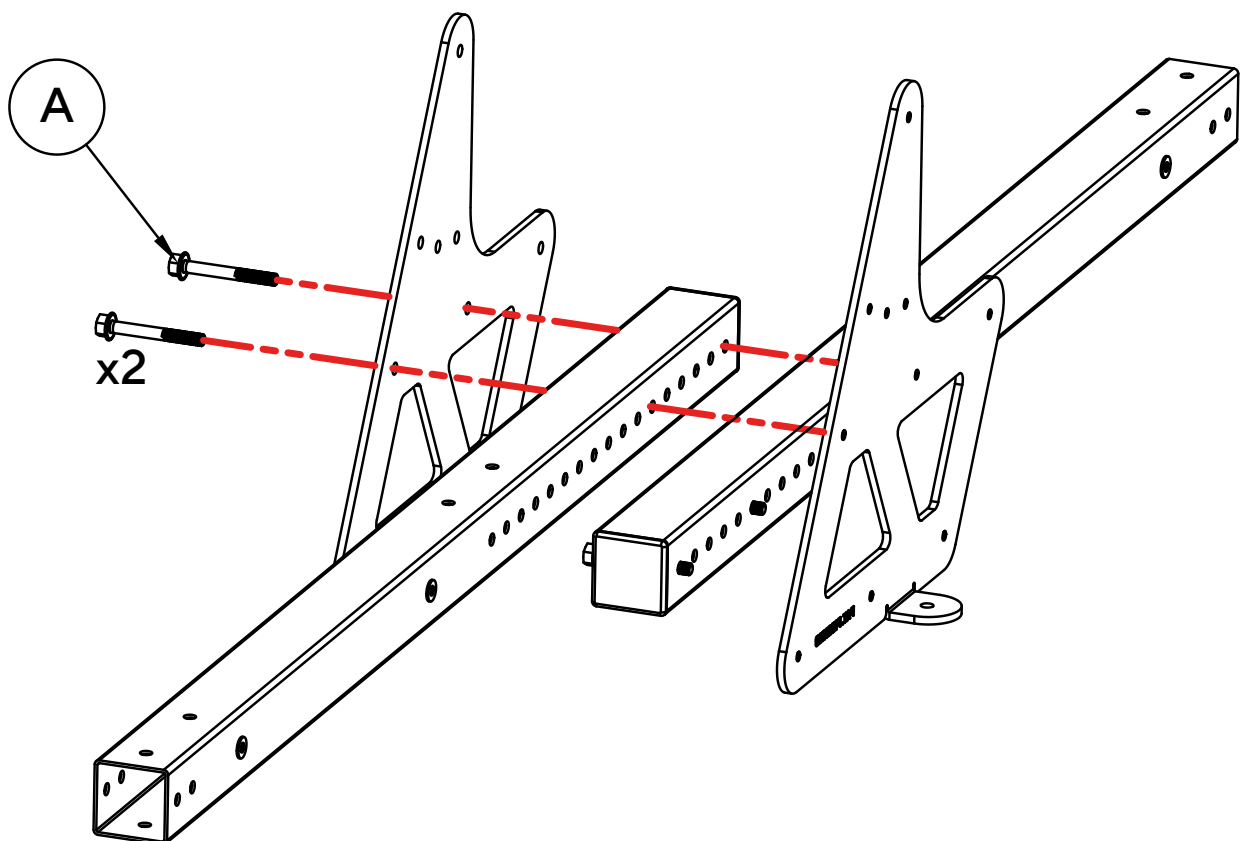
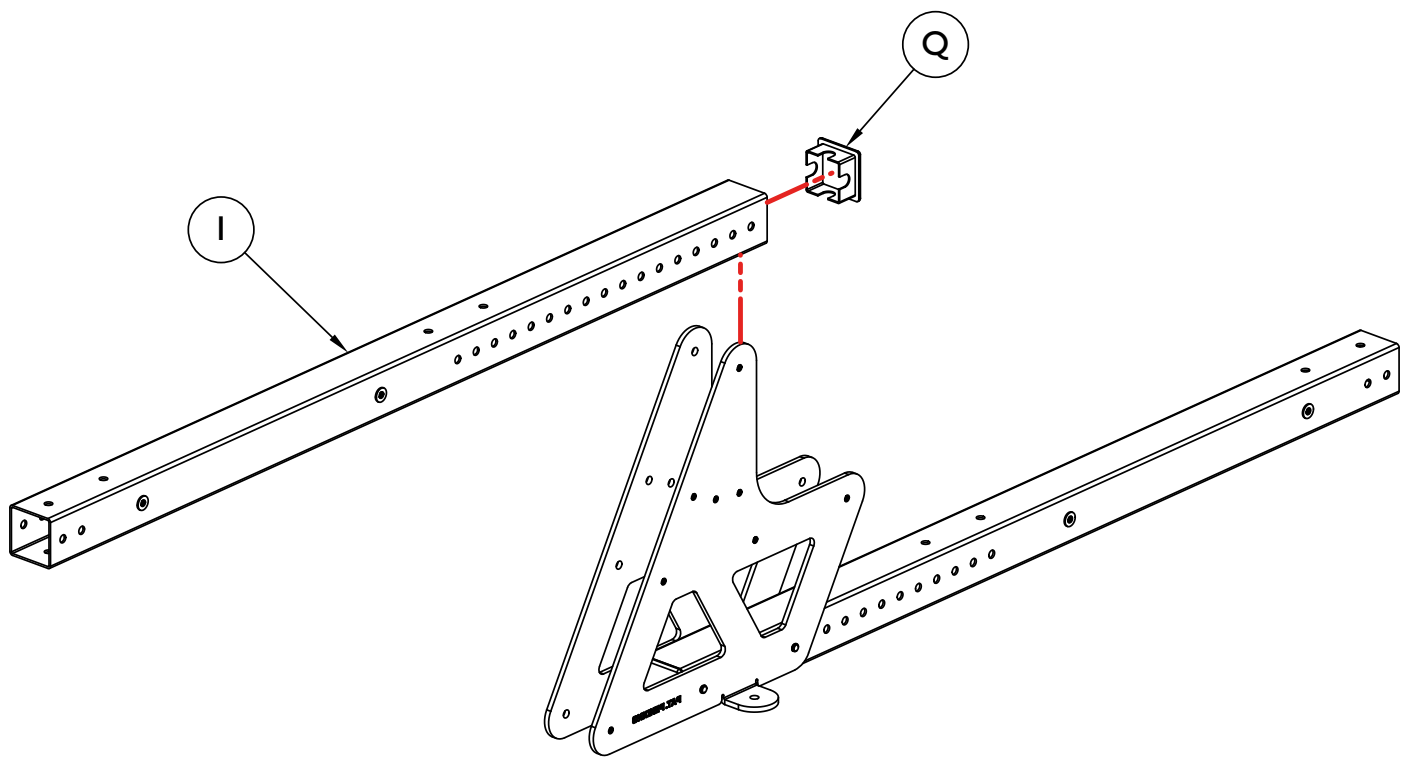

5.

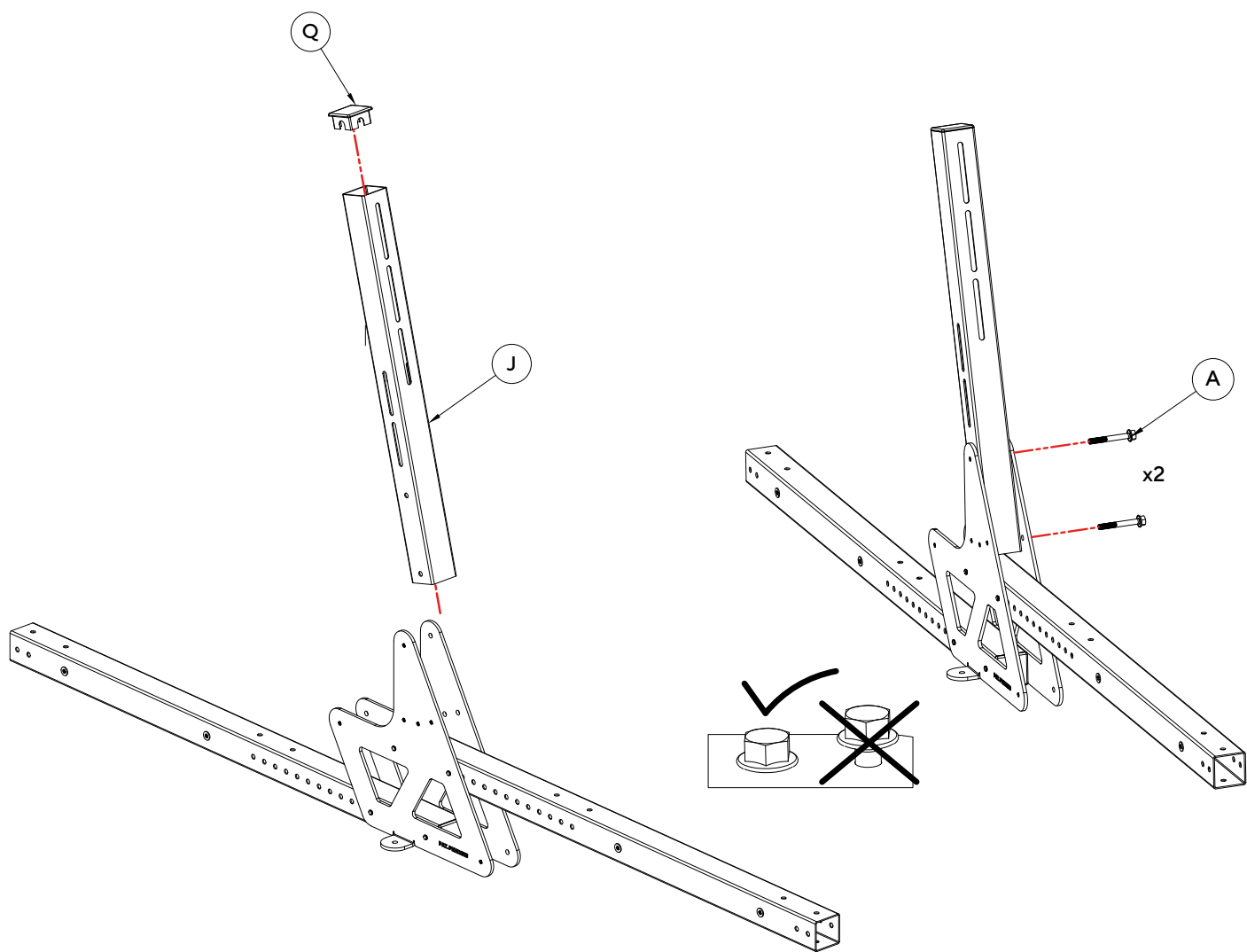
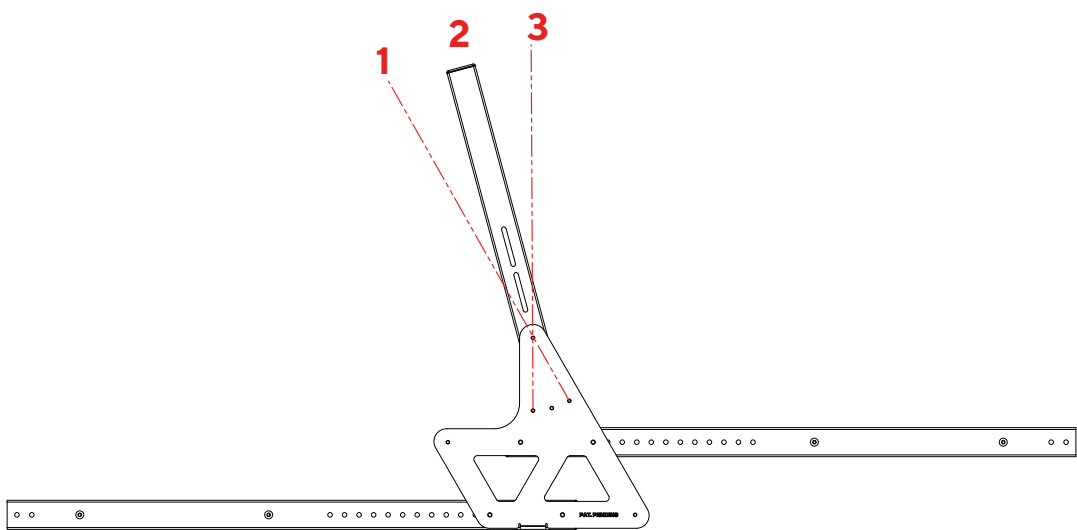

6.

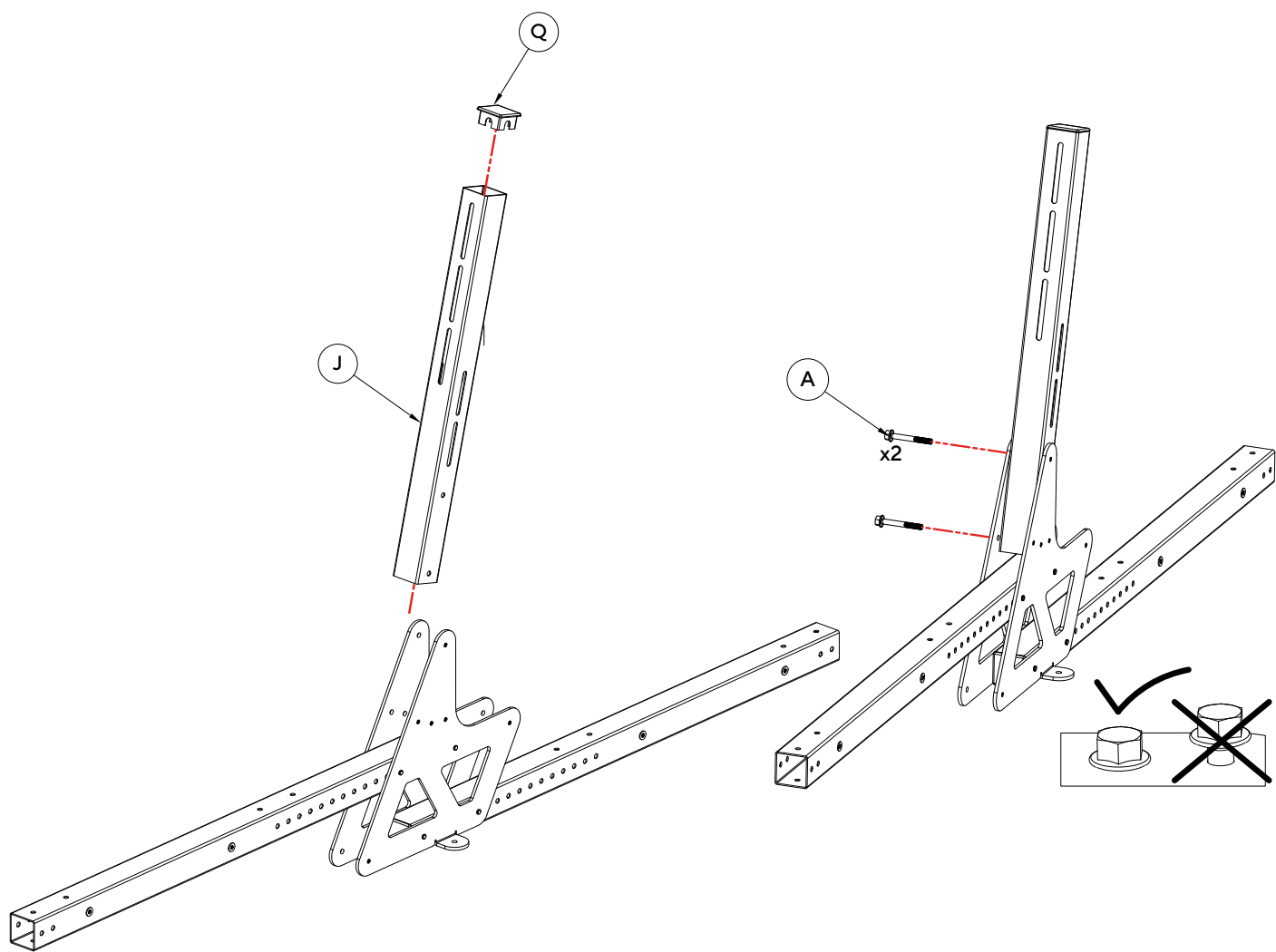
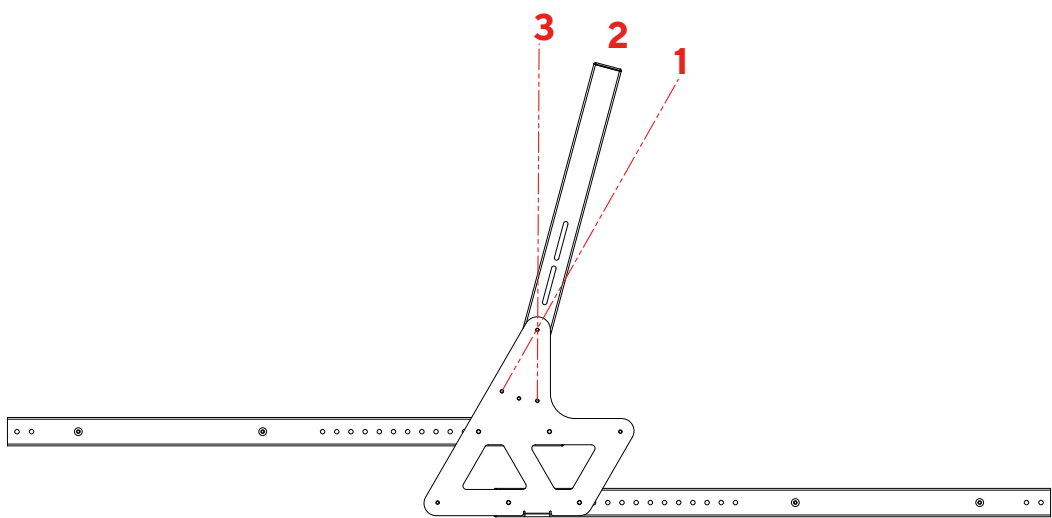

7.

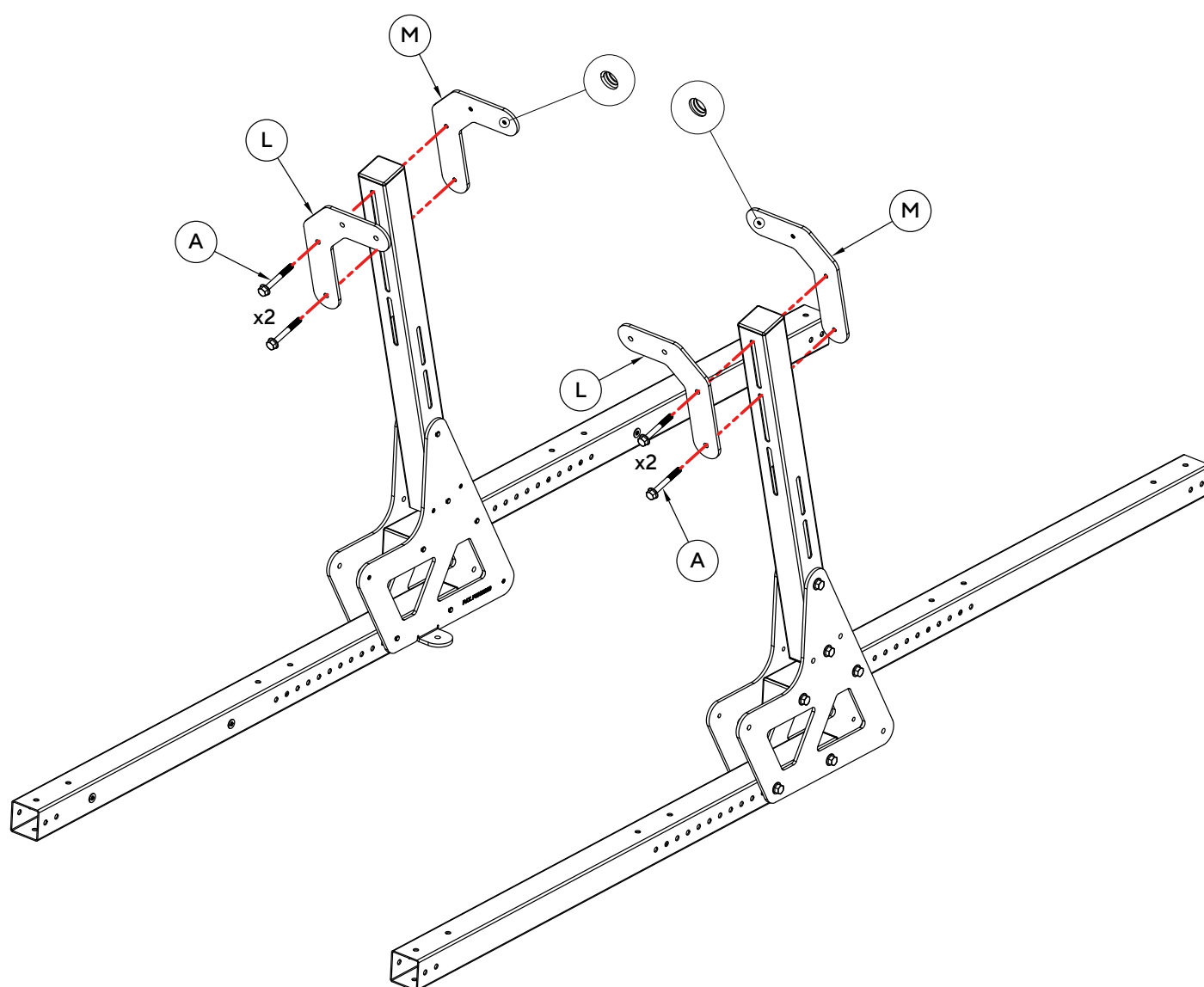

8.

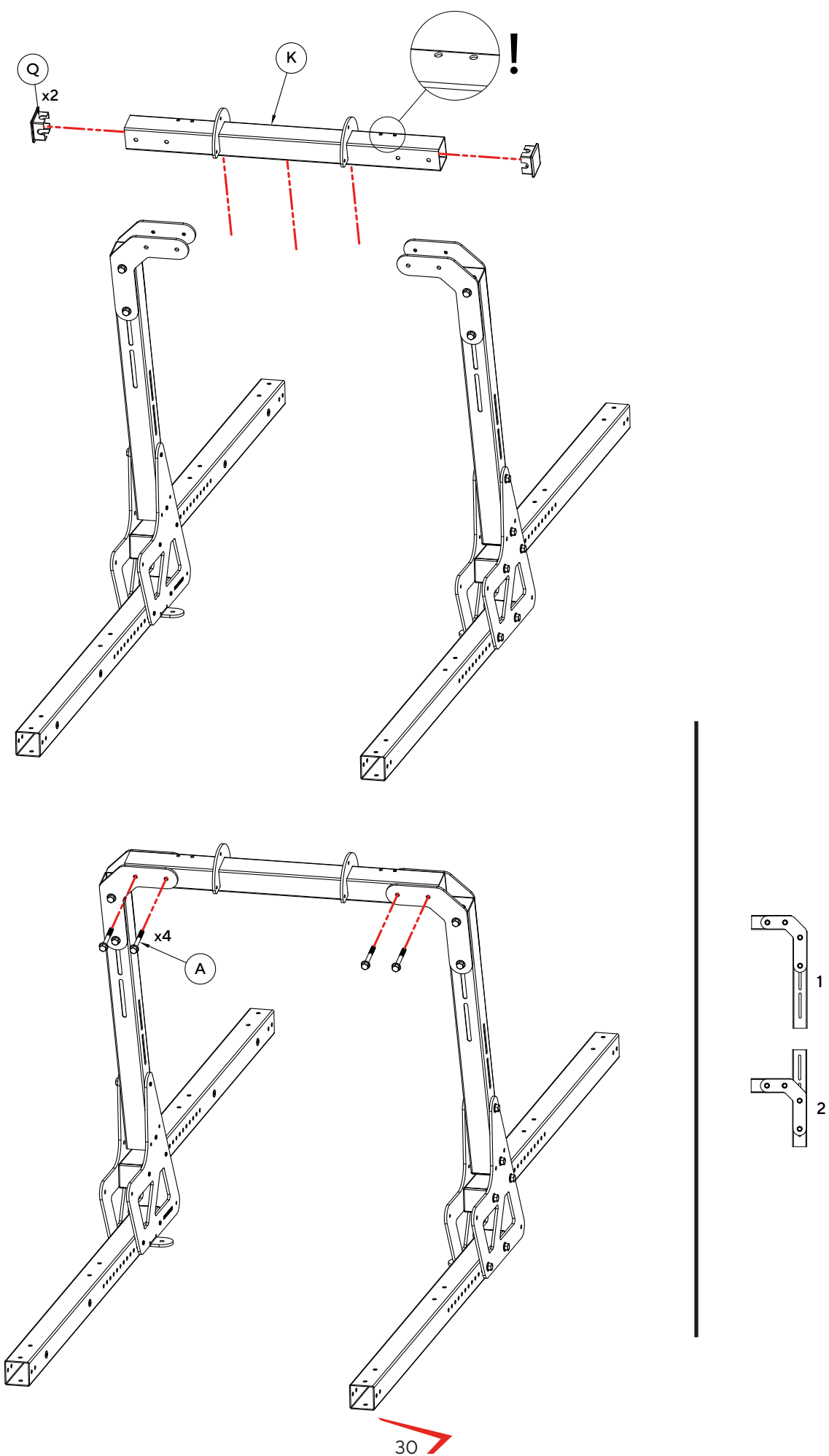

9.

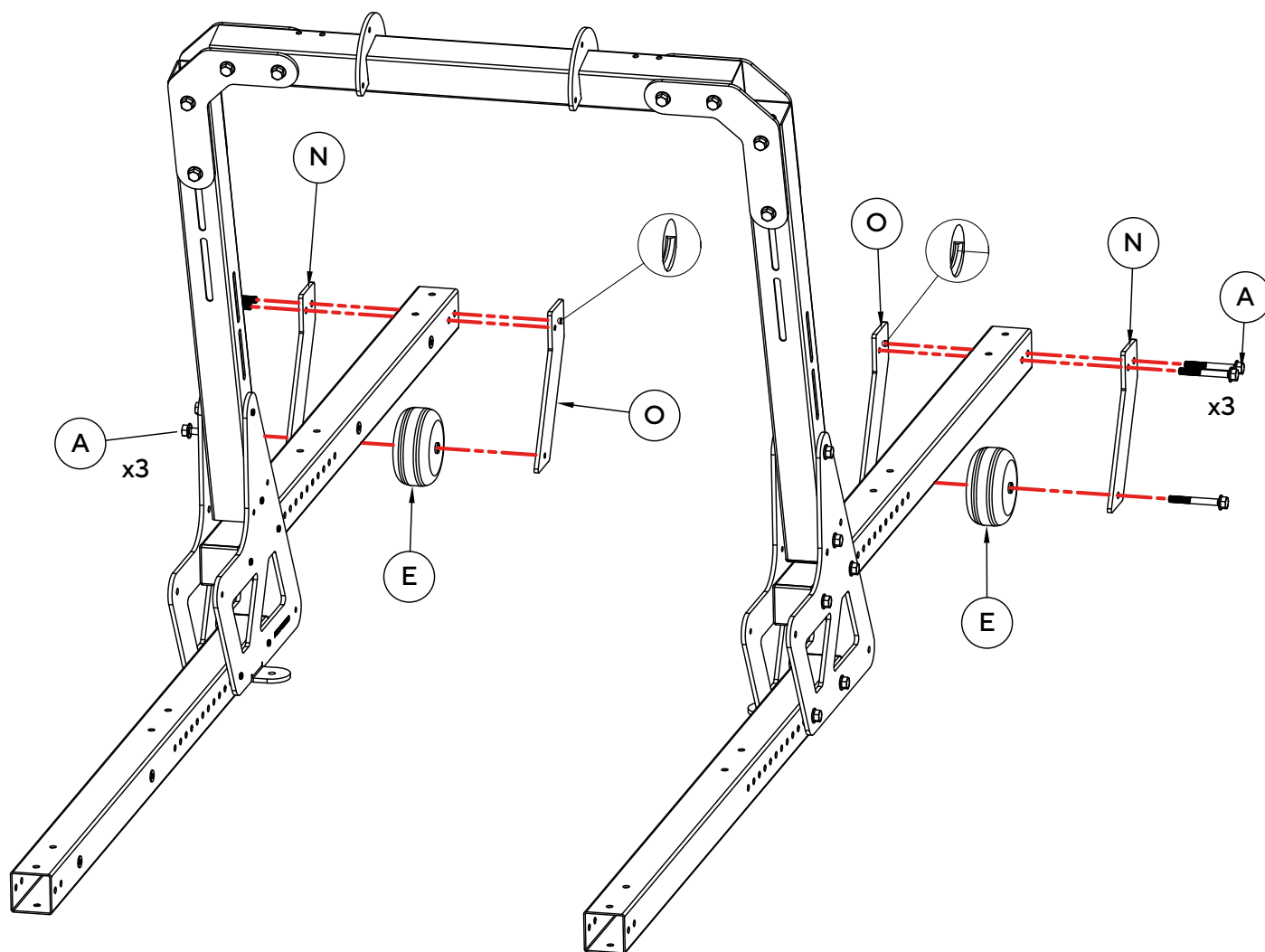

10.

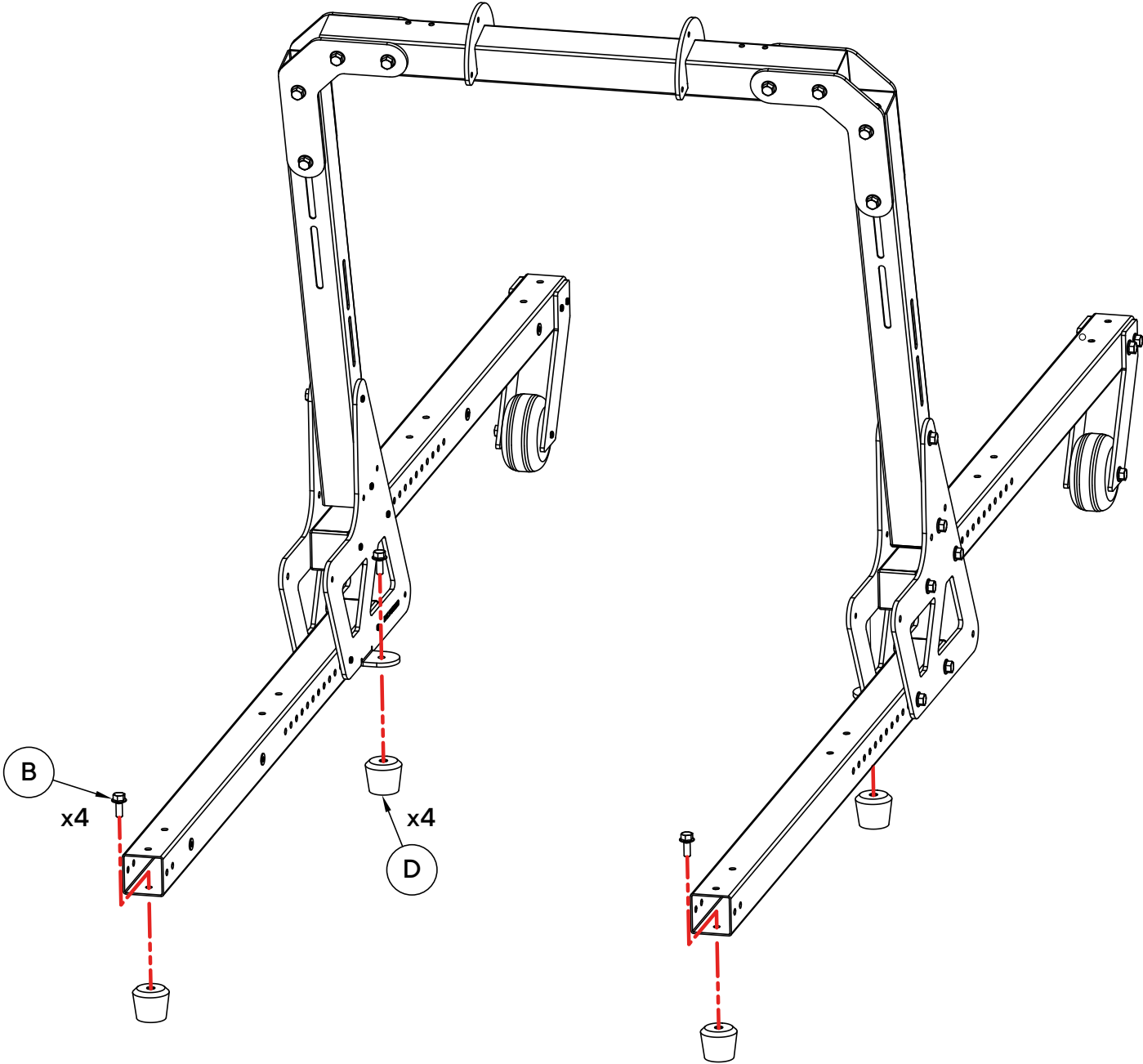

11.

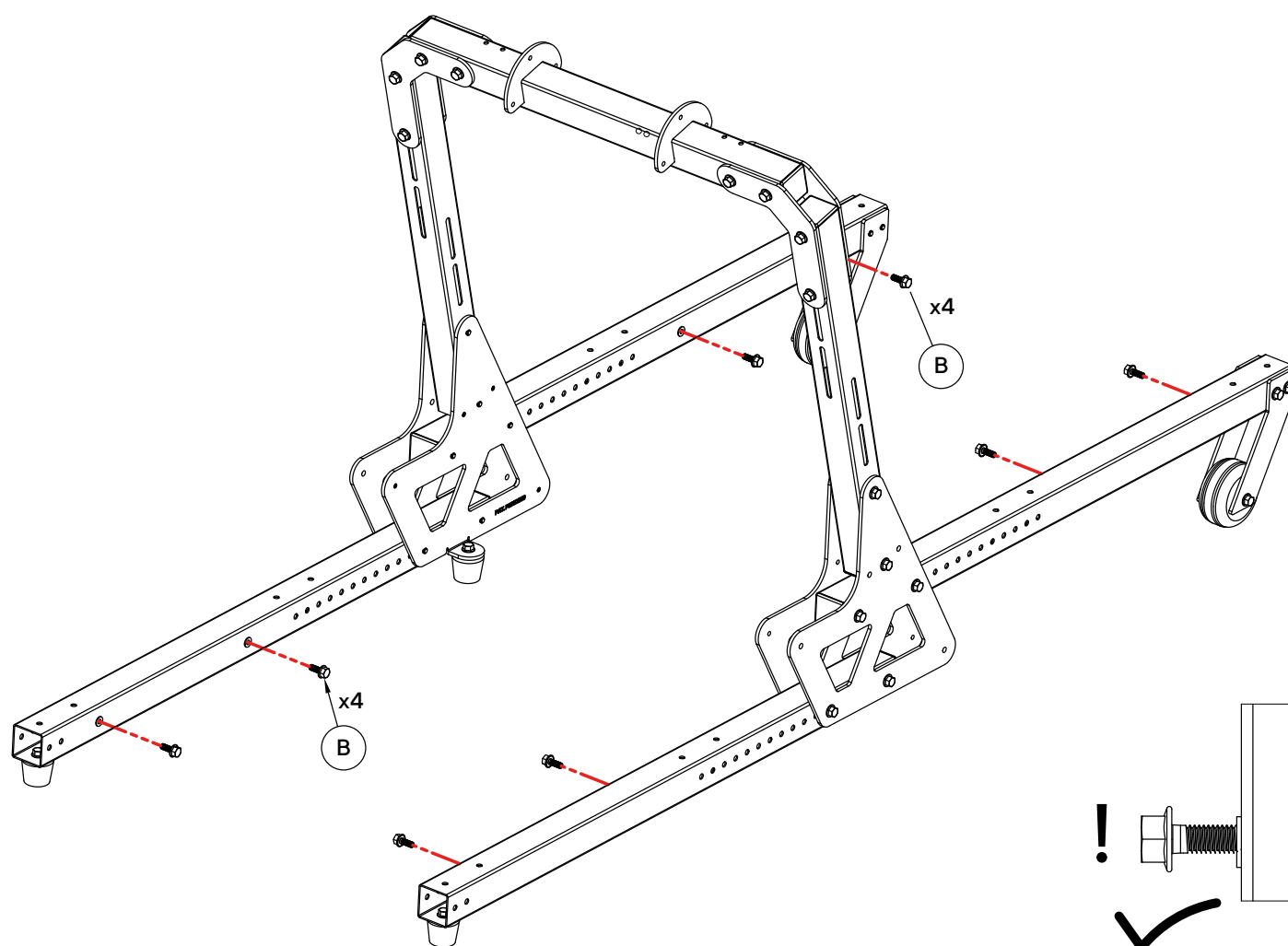

12. Pedal and seat compatibility

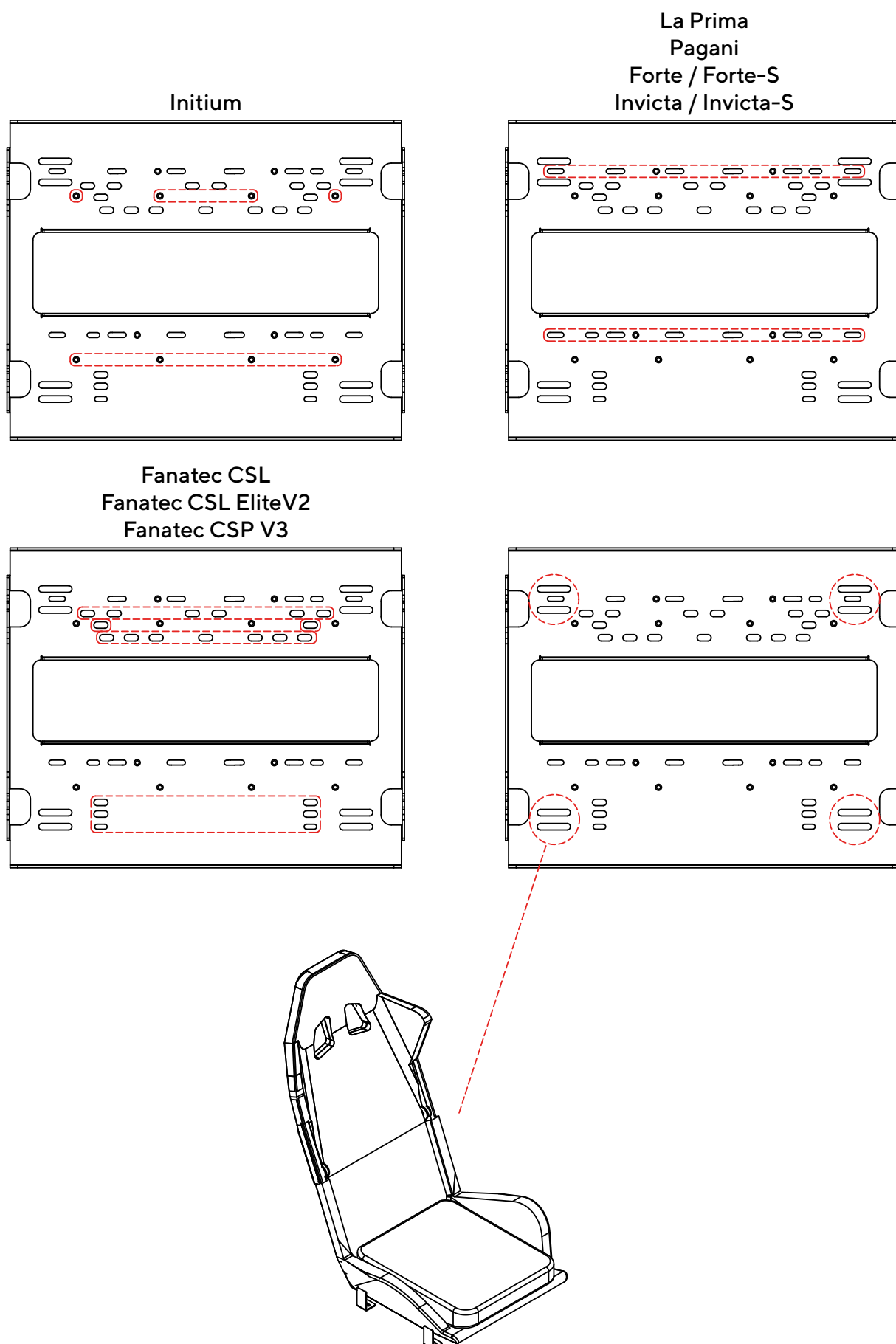

Moza CRP
Moza SRP

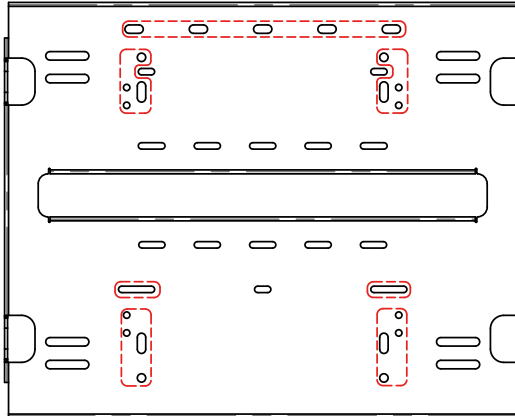

Thrustmaster T-LCM
Thrustmaster T3PA
Thrustmaster T3PM

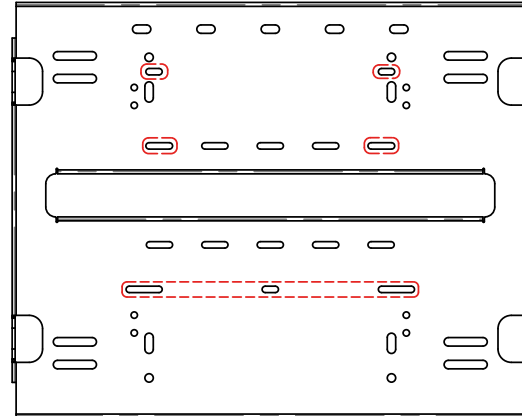

Logitech G Pro Racing

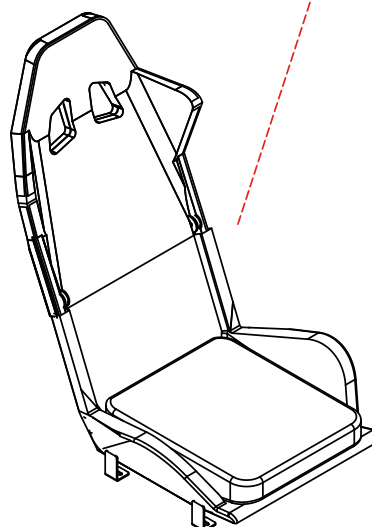
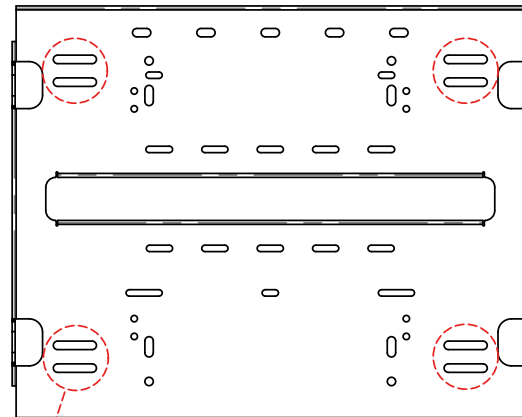
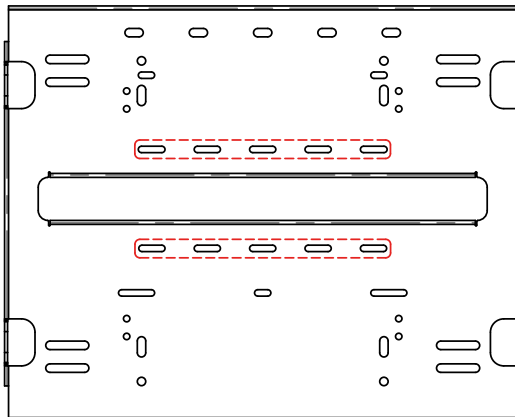

13.

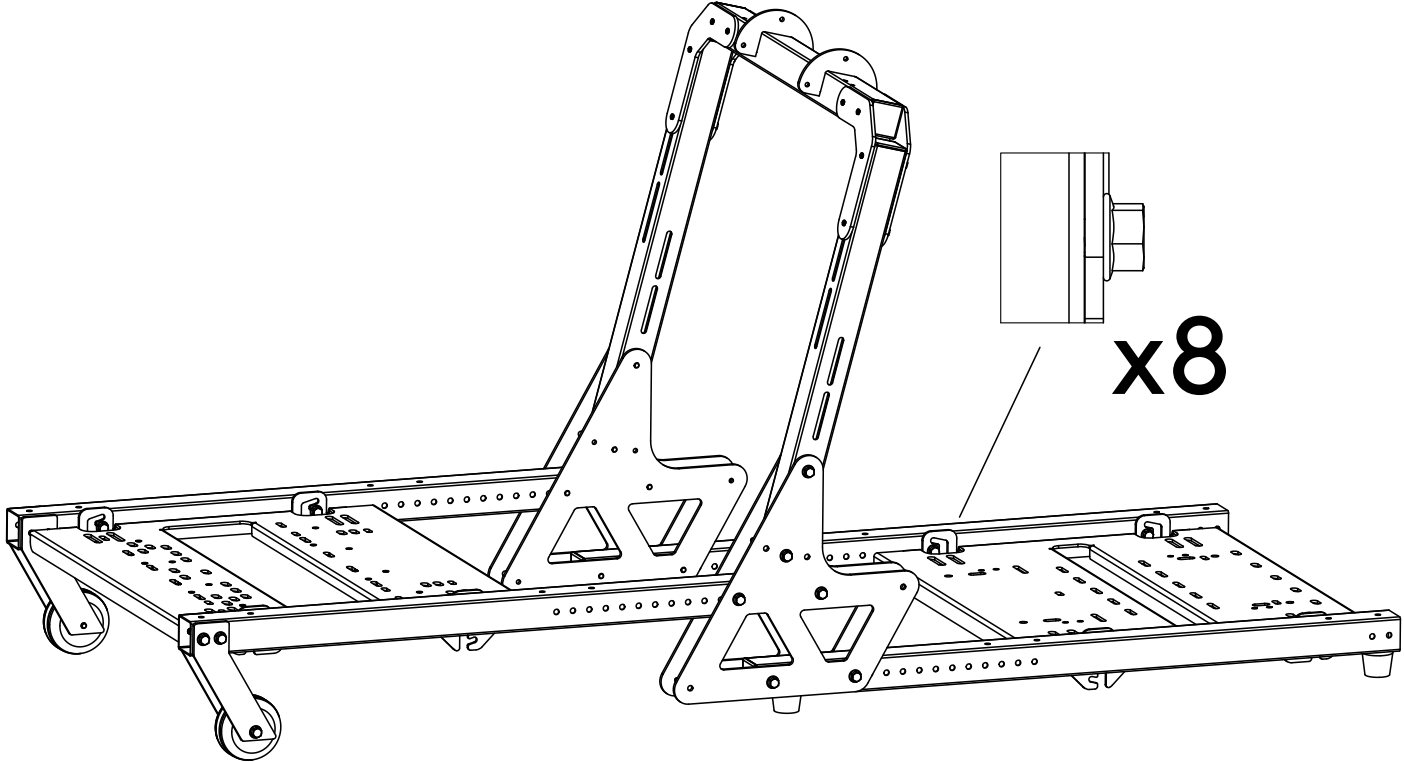
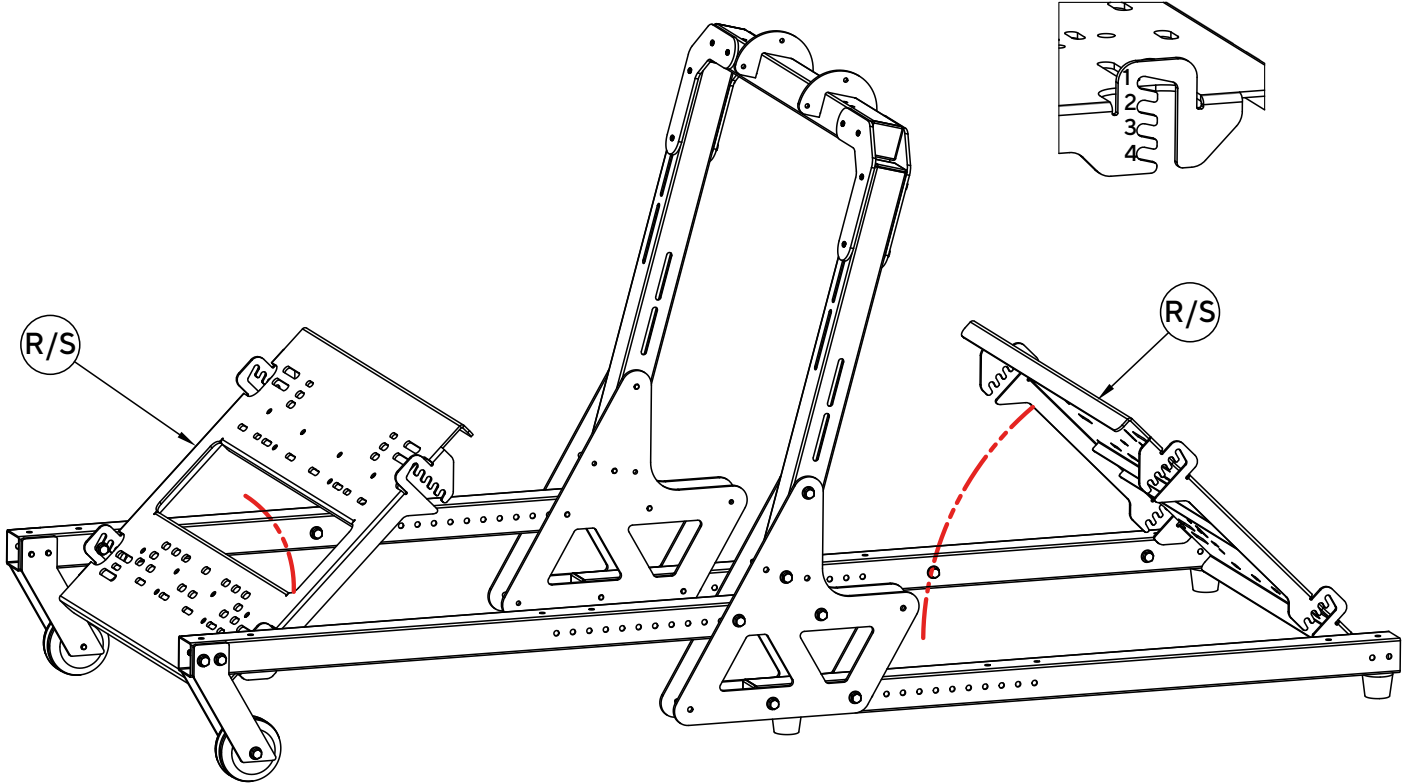

14.

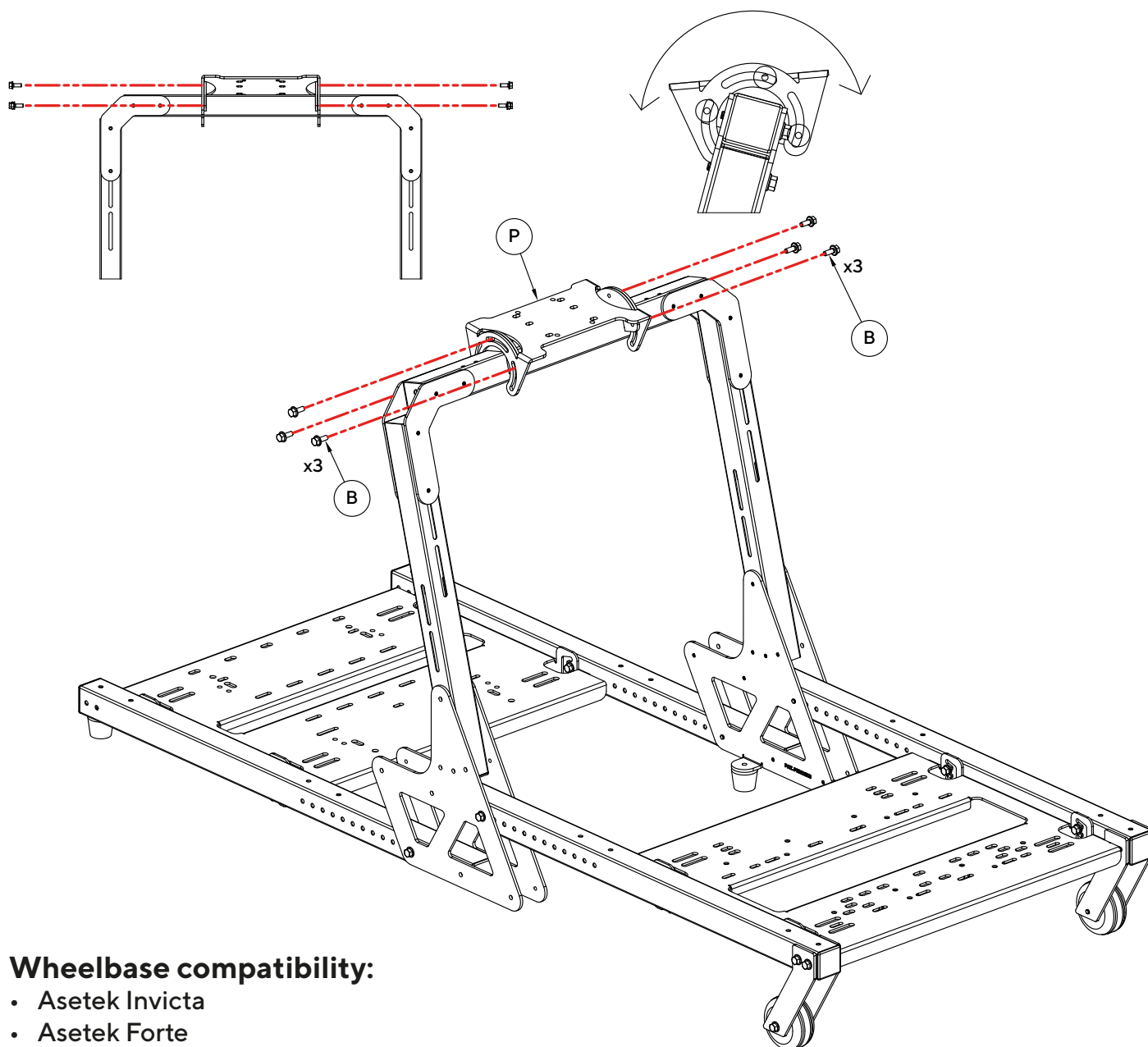

Wheelbase compatibility:

- Asetek Invicta
- Asetek Forte
- Asetek La Prima
- Asetek Initium
- Fanatec Podium DD1/DD2
- Fanatec Clubsport DD
- Fanatec Clubsport DD+
- Fanatec Clubsport DD Pro
- Fanatec CSL DD
- Thrustmaster T818
- Moza R3
- Moza R5
- Moza R9
- Moza R12
- Moza R16
- Moza R21

15.

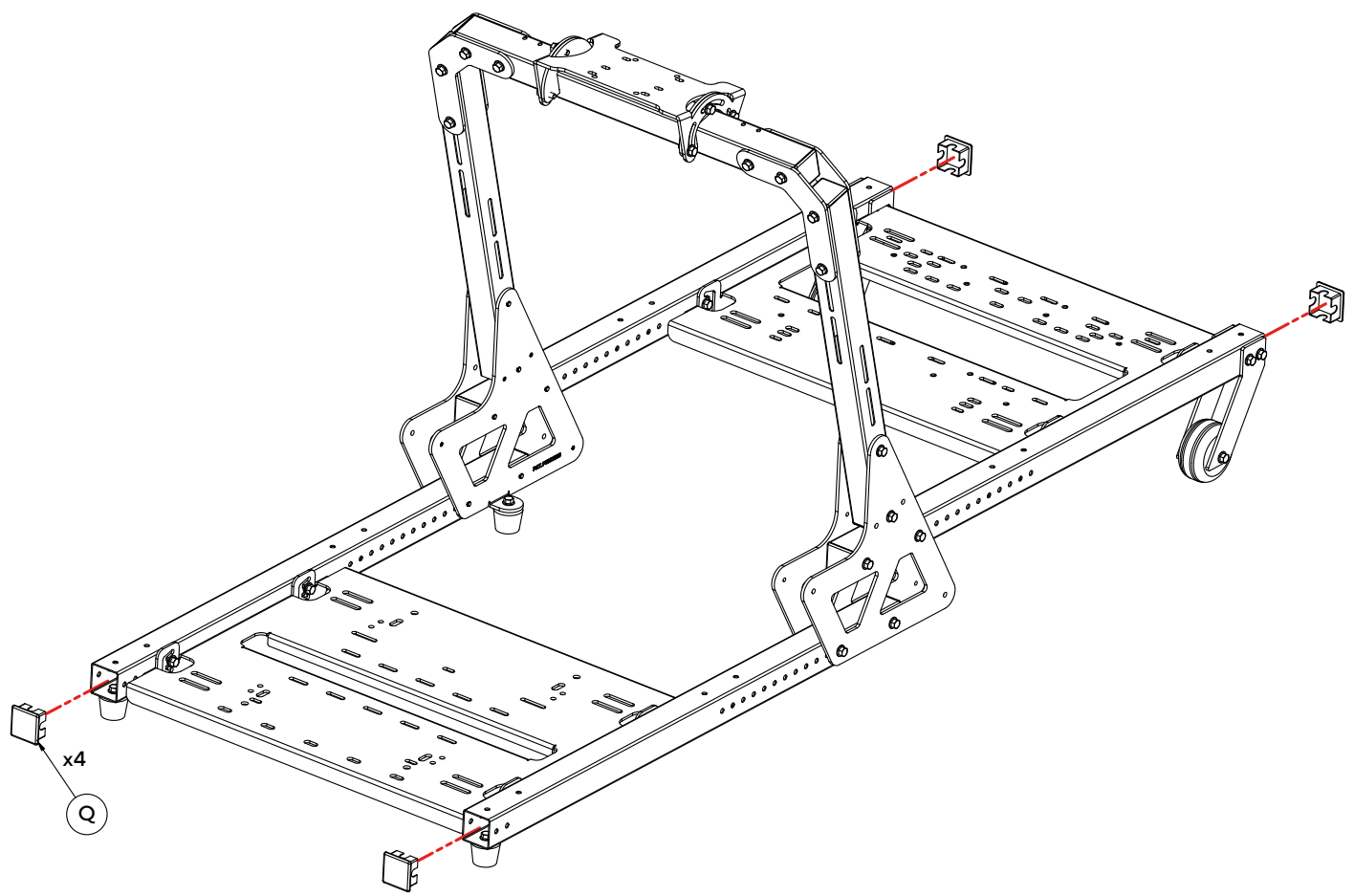

4. Troubleshooting

<https://www.asetek.com/simsports/knowledge-base/>



5. De-commissioning & Sustainability

At Asetek we are fiercely committed to making the world a sustainable place. You can read more about Asetek's sustainability efforts, including our sustainability reports, here: www.asetek.com/company/sustainability



This symbol indicates that this product should not be thrown away with other household waste throughout the EU. To prevent possible harm to the environment or human health by uncontrolled waste disposal, you are responsible for recycling it so that it can promote the sustainable reuse of raw materials. To return your used product, you can use the regular return and collection systems.

5.1 Packaging

All packaging is made of paper and cardboard. All our cardboard and paper products are labeled with the FSC mark, ensuring maximum reusability and that the forests are sustainably forested. Furthermore, we regularly check our vendors to make sure they are upholding their commitments. About FSC: www.fsc.org/en/fsc-labels

If you need to dispose of your packaging, please use the appropriate paper waste stream in your country, to dispose of the packaging. Naturally, we hope you want to keep it around – we are quite proud of it

5.2 Product

If you feel uncertain about how to recycle any Asetek SimSports® or Asetek Racing™ product, we suggest getting in touch with our dedicated customer support team, who will happily help you.

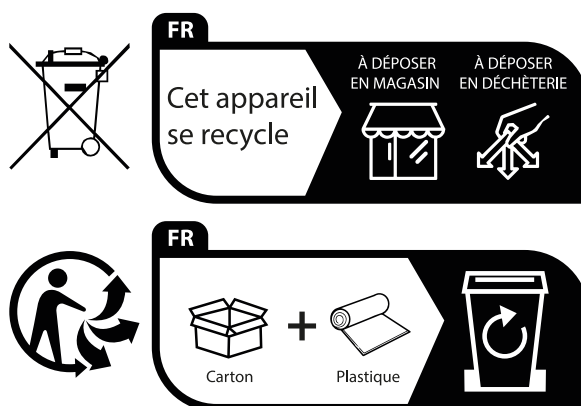

Points de collecte sur www.quefairedemesdechets.fr
Privilégiez la réparation ou le don de votre appareil !

***WHERE REAL
RACING STARTS***