

Congratulations on your new
Asetek Racing™ Initium™ Monitor Mount

This manual is written for the end-user of the Asetek Racing™ Initium™ Monitor Mount and contains all the information required to correctly and safely install and use your new product.

WARNING:

- Choking Hazard – Small parts. Not for children under 3 years.
 - Do not use power tools to assemble or attach the monitor mount to avoid damaging the parts or overtightening the screws.
 - Assembly of the monitor mount is allowed only by an instructed person who understands and follows the above safety instructions.
 - If the monitor mount becomes damaged in any way, stop using it immediately and contact Asetek support or the reseller from whom you bought it.
 - Operating environment:
 - 0°C – 40°C room temperature, non-condensing humidity
 - Indoor use only
- Warranty**

Asetek SimSports® offers 24 Month warranty on all products.

Box Contents

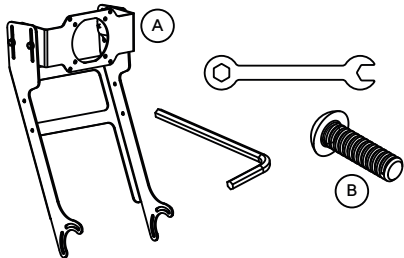

Getting Started

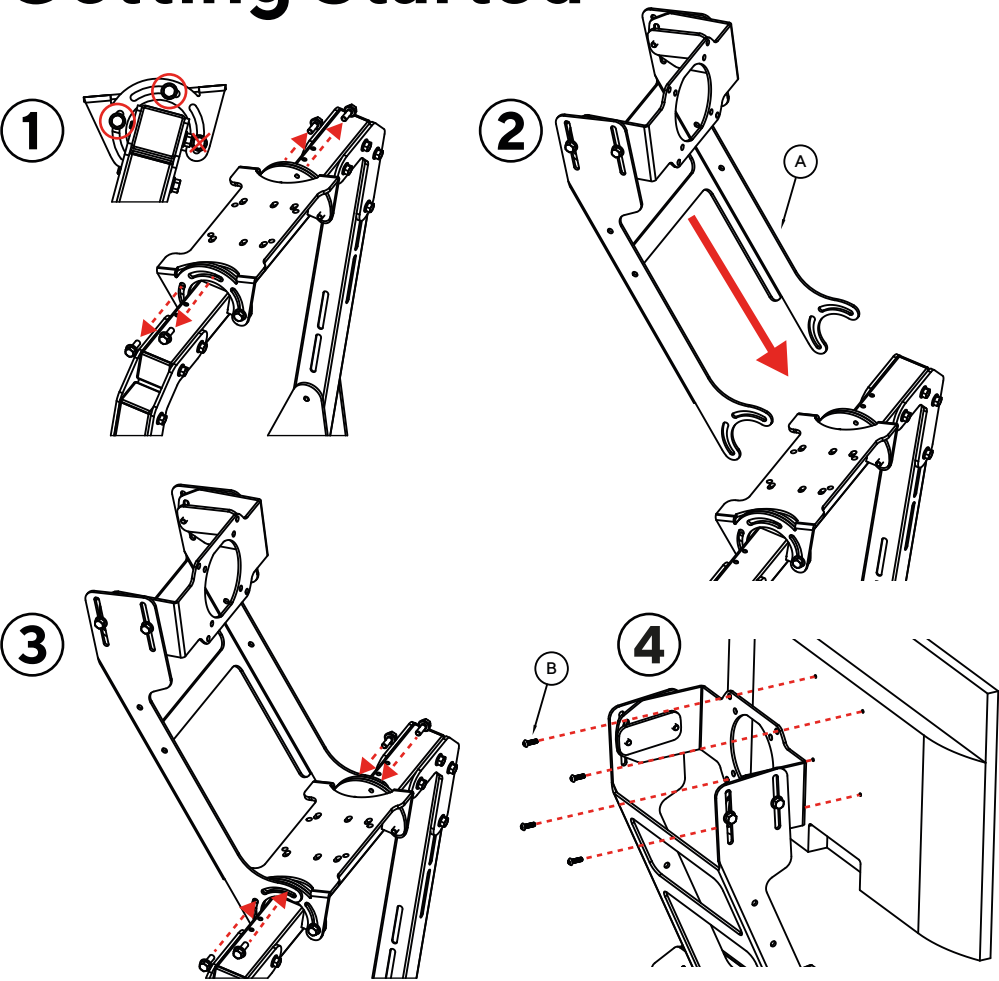

Settings

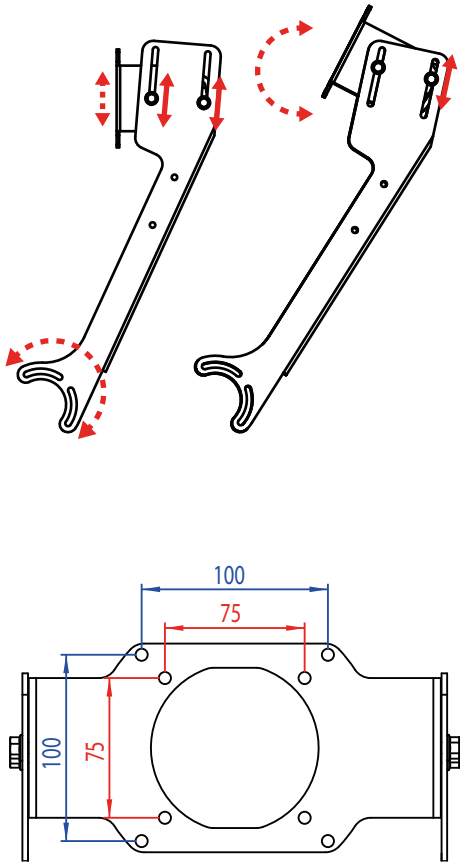

Need Assistance?

Support



Knowledge base



Manual Version 1.0

Videos



De-commissioning & Sustainability
At Asetek we are fiercely committed to making the world a sustainable place.
www.asetek.com/company/sustainability

Packaging
All packaging is made of paper and cardboard. All our cardboard and paper products are labeled with the FSC mark, ensuring maximum reusability and that the forests are sustainably forested. Furthermore, we regularly check our vendors to make sure they are upholding their commitments.

About FSC: www.fsc.org/en/fsc-labels

If you need to dispose of your packaging, please use the appropriate paper waste stream in your country, to dispose of the packaging. Naturally, we hope you want to keep it around – we are quite proud of it.

Product
If you feel uncertain about how to recycle any Asetek SimSports® or Asetek Racing™ product, we suggest getting in touch with our dedicated customer support team, who will happily help you.





FR
Cet appareil
se recycle

A DÉPOSER
EN MAGASIN



A DÉPOSER
EN DÉCHÈTÈRE







FR
Cet appareil
se recycle

Carton



Plastique





Points de collecte sur www.quefairemedesdechets.fr
Privilégiez la réparation ou le don de votre appareil !