

## Box Contents:

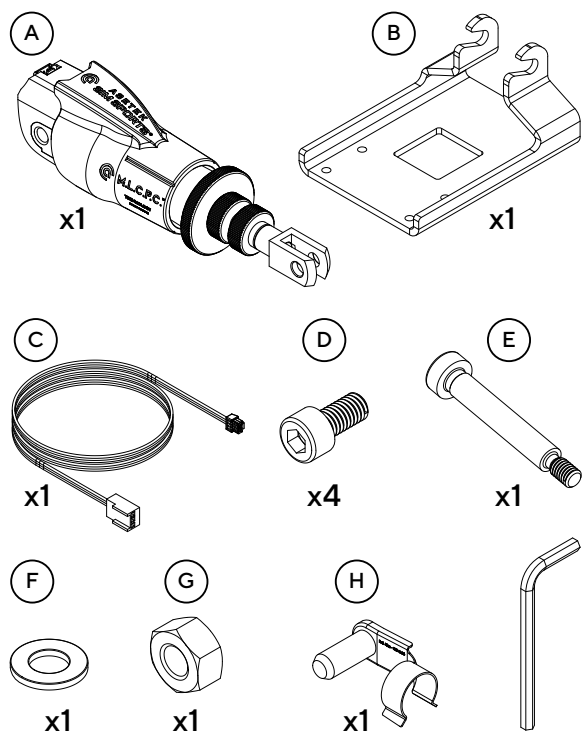

Product Code: 40-014-0014004  
Product name: Initium™ Load Cell Brake Upgrade

## Congratulations on your new Asetek Racing™ Initium™ Load Cell Brake Upgrade



**ASETEK**  
**RACING**

This manual is written for the end-user of the Asetek Racing™ Initium™ Load Cell Brake Upgrade and contains all the information required to correctly and safely install and use your new product.

**INITIUM™**

## WARNING:

- Choking Hazard – Small parts. Not for children under 3 years.
- Do not use power tools to assemble or attach the Initium™
- Load Cell Brake Upgrade to avoid damaging the parts or overtightening the screws.
- Mounting and/or use of any parts in a vehicle will void the warranty.
- Do not disassemble this product beyond what is described in the product manual.
- Make sure all parts are secured tightly before use.
- Please be aware that edges on the rod clevis can be sharp.
- Assembly of the Initium™ Load Cell Brake Upgrade is allowed only by an instructed person who understands and follows the above safety instructions.
- If the Initium™ Load Cell Brake Upgrade becomes damaged in any way, stop using it immediately and contact Asetek support or the reseller from whom you bought it.
- Operating environment:
  - 0°C – 40°C room temperature, non-condensing humidity
  - Indoor use only

### Warranty

Asetek SimSports® offers 24 Month warranty on all products.

## Need Assistance?

Support



Knowledge base



Videos



Manual Version 1.0

## Assembly:



Pedals with this upgrade kit can only be used in Cockpit Mode. Follow the instructions in the pedal manual on how to put the pedals in the Cockpit mode.

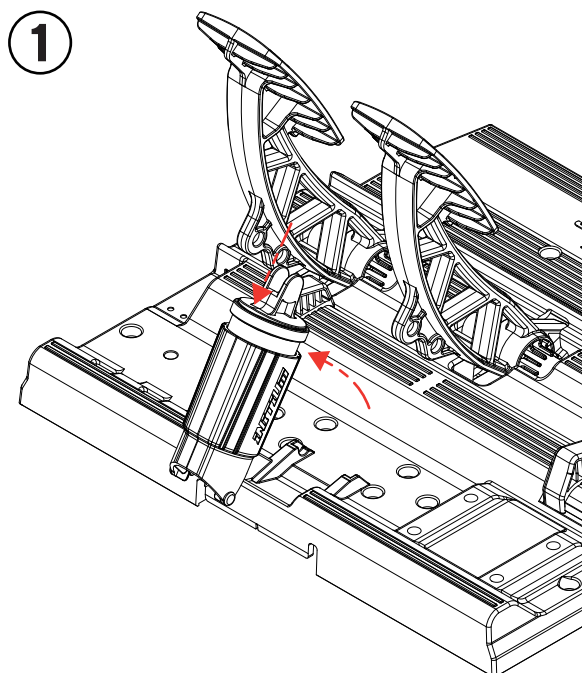

2

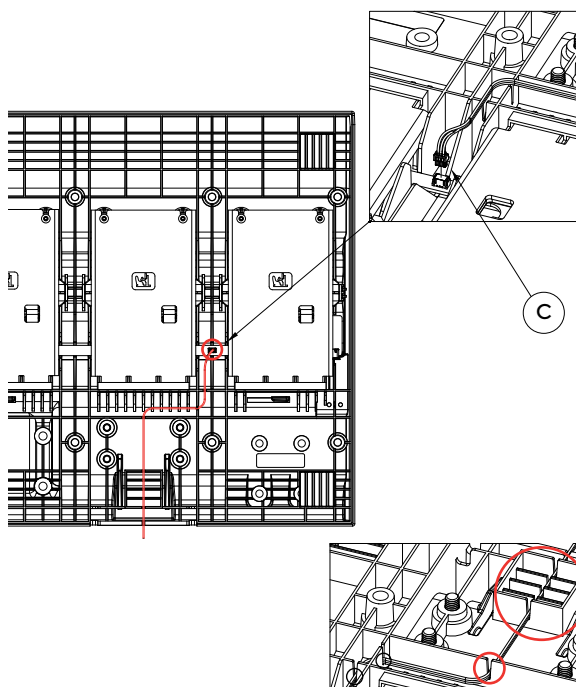

3

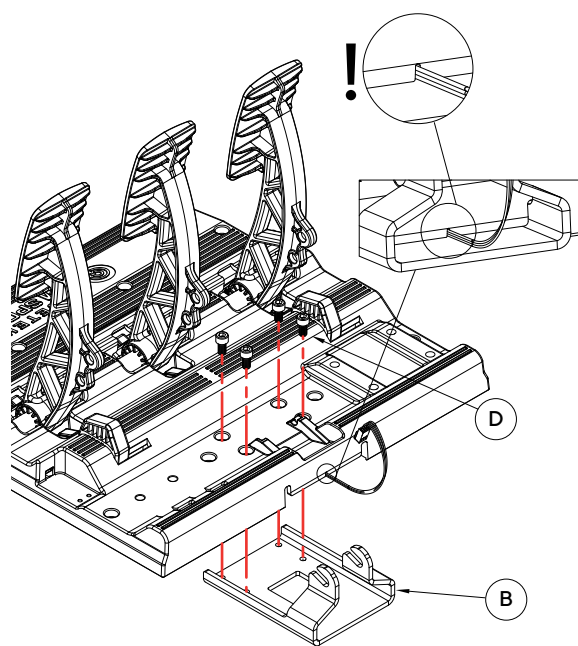

4

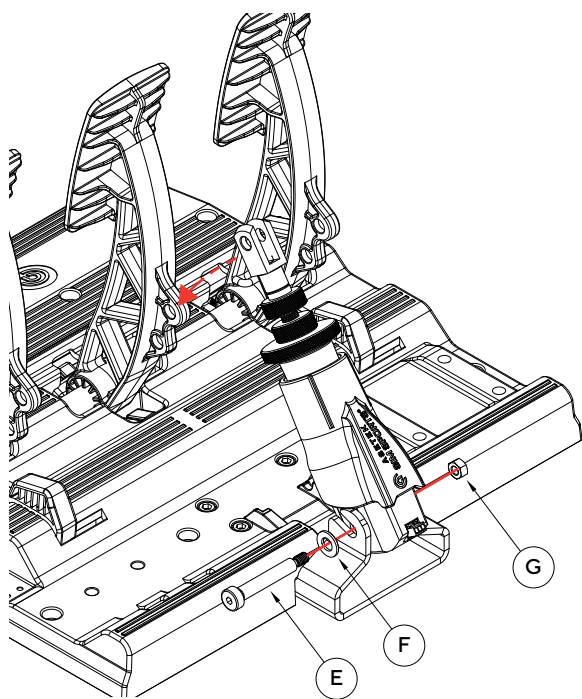

5

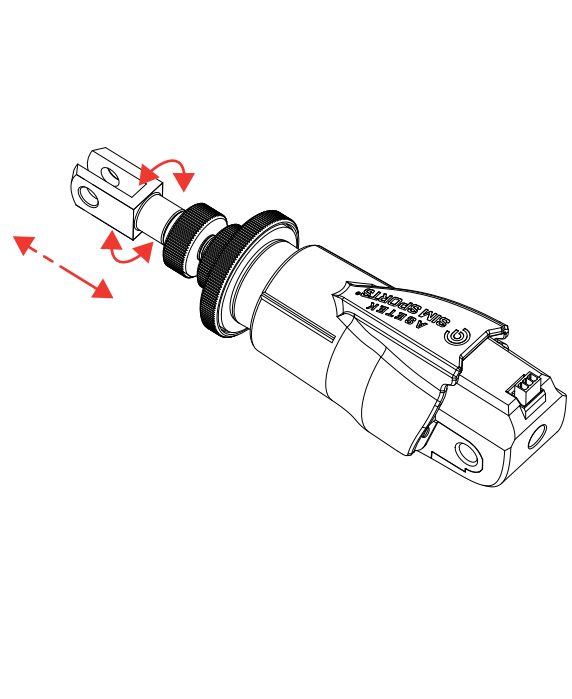

6

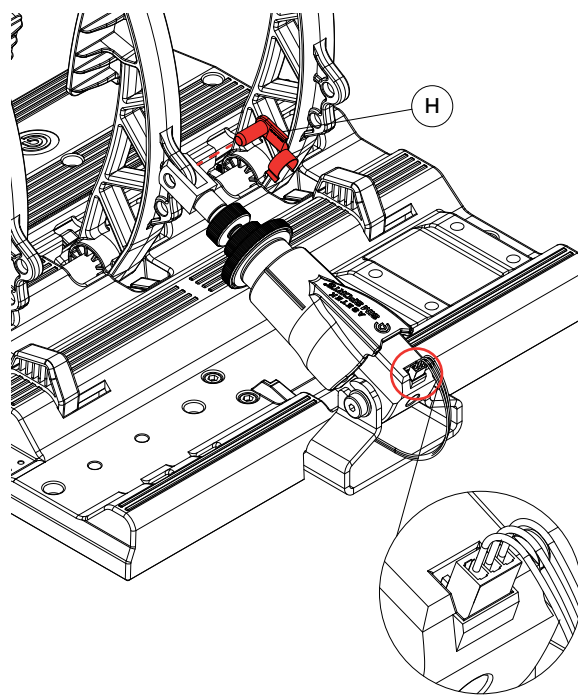

7

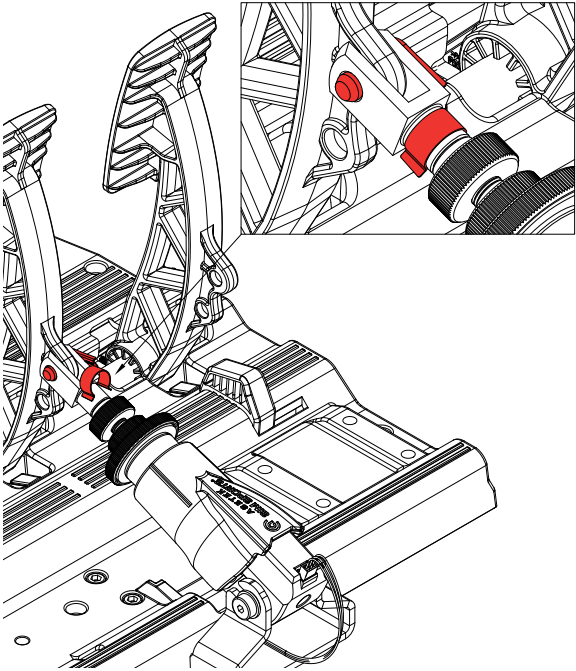

## Settings: Preload Adjustment

1. Turning clockwise, loosen the uppermost thumbnut. It is the one closest to the pedal itself.

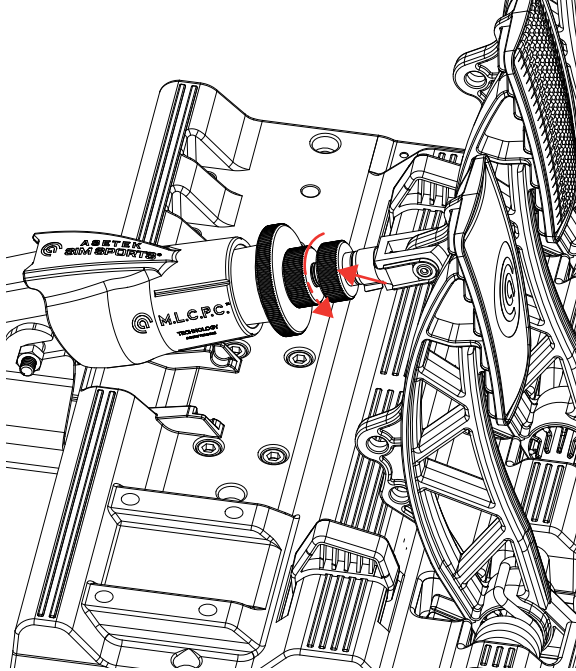

2. Rotate the piston to adjust the amount of preload on your brake:
  - a. Clockwise to decrease the simulated distance between the disc and the caliper/pad. This will immediately engage the brake when you put your foot on it.
  - b. Counterclockwise to increase the simulated distance between the disc and caliper/pad. This will give you some play in the brake pedal before you actively engage the brake.
  - c. If you can't reach the desired gap, you may have to loosen the clevis thumbnut (the one closest to the clevis) and adjust the pushrod itself.

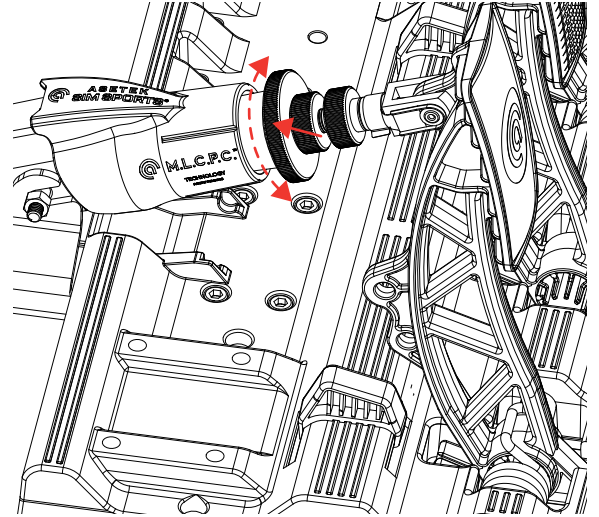

3. Re-tighten the thumbnut and rotate clockwise, while holding the piston firm, until it locks up against the piston.

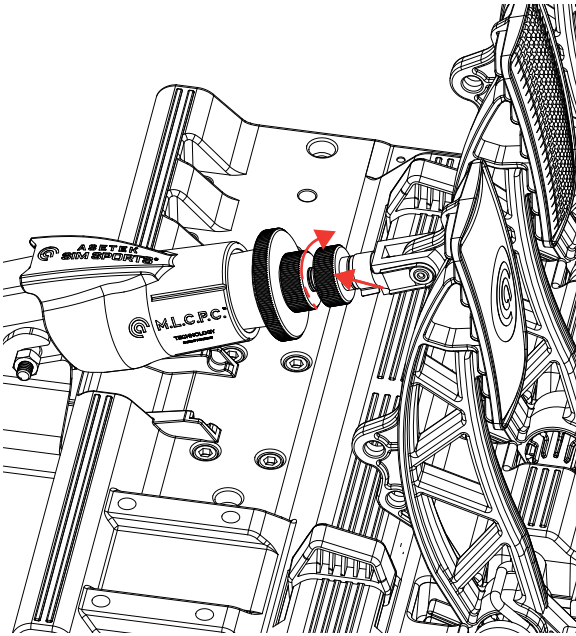

4. Calibrate your Brake in RaceHub™.

## Settings: Swapping Elastomers

1. To swap the elastomers, loosen the thumbnut locking the pedal arm to brake cylinder by turning it clockwise. It is the one closest to the pedal arm.

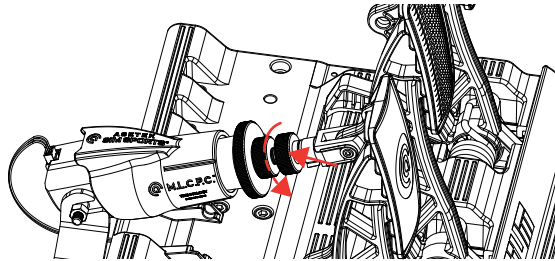

2. Remove the clevis lock pin.

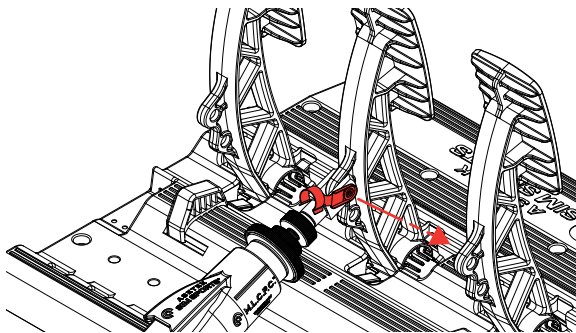

3. Lift the brake cylinder.

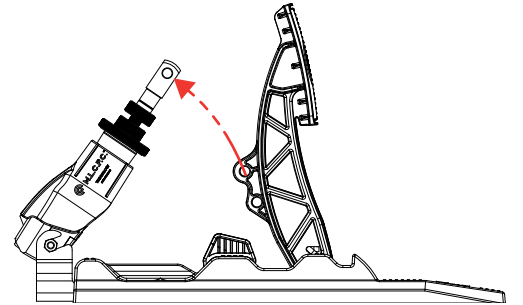

4. Carefully remove the rod from the brake cylinder.

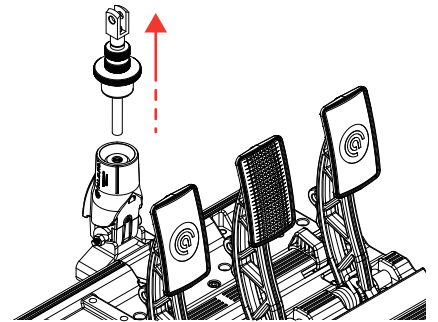

5. Carefully remove the elastomer with your fingers. If you can't do it with your fingers, use the pushrod spring to pull it out.

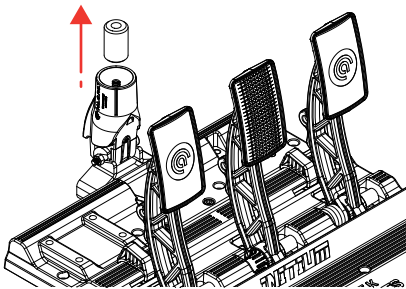

6. Carefully insert your preferred elastomer around the spring.

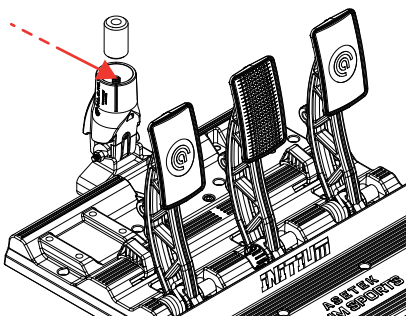

7. Grab the rod and carefully insert into the elastomer and over the spring.

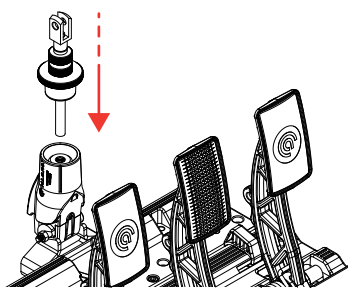

8. Re-insert the clevis lock pin and retighten the locking thumbnut.

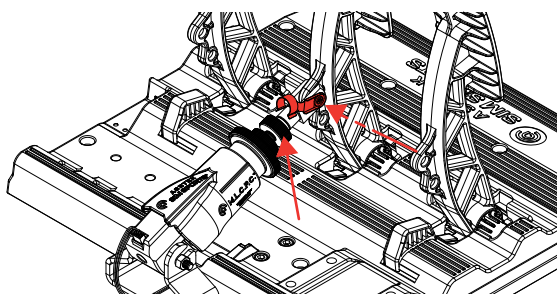

9. Recalibrate the brake in RaceHub™.

## De-commissioning & Sustainability:

At Asetek we are fiercely committed to making the world a sustainable place. [www.asetek.com/company/sustainability](http://www.asetek.com/company/sustainability)

### Packaging

All packaging is made of paper and cardboard. All our cardboard and paper products are labeled with the FSC mark, ensuring maximum reusability and that the forests are sustainably forested. Furthermore, we regularly check our vendors to make sure they are upholding their commitments.

About FSC: [www.fsc.org/en/fsc-labels](http://www.fsc.org/en/fsc-labels)

If you need to dispose of your packaging, please use the appropriate paper waste stream in your country, to dispose of the packaging. Naturally, we hope you want to keep it around – we are quite proud of it.

### Product

If you feel uncertain about how to recycle any Asetek SimSports® or Asetek Racing™ product, we suggest getting in touch with our dedicated customer support team, who will happily help you.

