

## Box Contents:

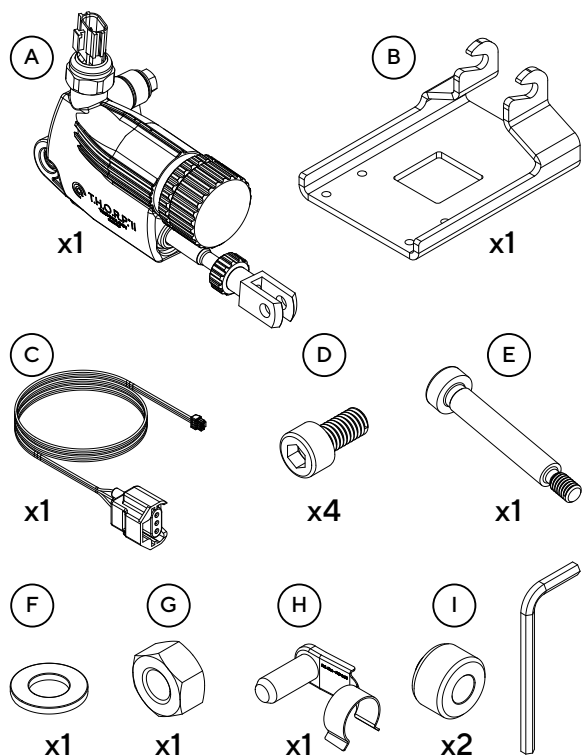

Product code: 40-014-0014005  
Product name: Initium™ Hydraulic Brake Upgrade

## Congratulations on your new Asetek Racing™ Initium™ Hydraulic Brake Upgrade



**ASETEK**  
**RACING**

This manual is written for the end-user of the Asetek Racing™ Initium™ Hydraulic Brake Upgrade and contains all the information required to correctly and safely install and use your new product.

**INITIUM™**

## WARNING:

- Choking Hazard – Small parts. Not for children under 3 years.
- Do not use power tools to assemble or attach the Initium™ Hydraulic Brake Upgrade to avoid damaging the parts or overtightening the screws.
- Mounting and/or use of any parts in a vehicle will void the warranty.
- Do not disassemble this product beyond what is described in the product manual.
- Make sure all parts are secured tightly before use.
- Please be aware that edges on the rod clevis can be sharp.
- Assembly of the Initium™ Hydraulic Brake Upgrade is allowed only by an instructed person who understands and follows the above safety instructions.
- If the Initium™ Hydraulic Brake Upgrade becomes damaged in any way, stop using it immediately and contact Asetek support or the reseller from whom you bought it.
- Operating environment:
  - 0°C – 40°C room temperature, non-condensing humidity
  - Indoor use only

### Warranty

Asetek SimSports® offers 24 Month warranty on all products.

## Need Assistance?



## Assembly:



Pedals with this upgrade kit can only be used in Cockpit Mode. Follow the instructions in the pedal manual on how to put the pedals in the Cockpit mode.

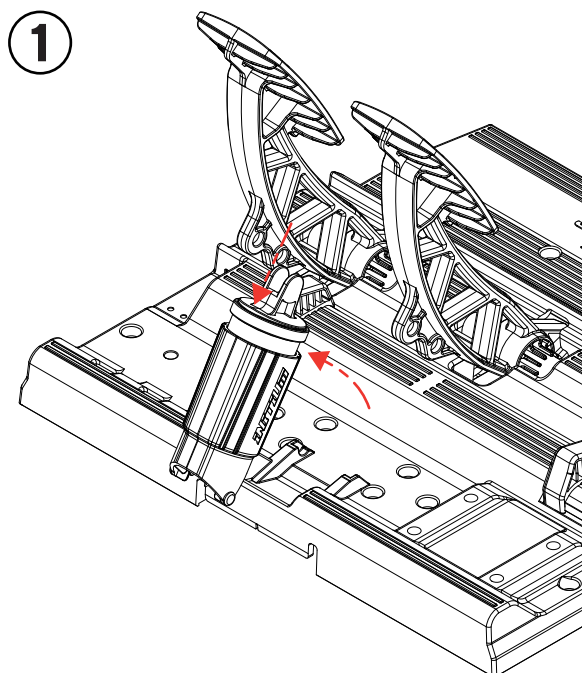

2

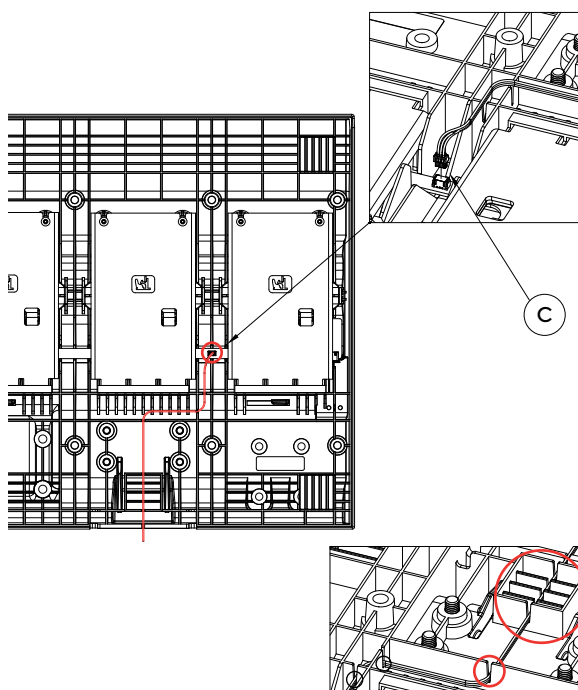

3

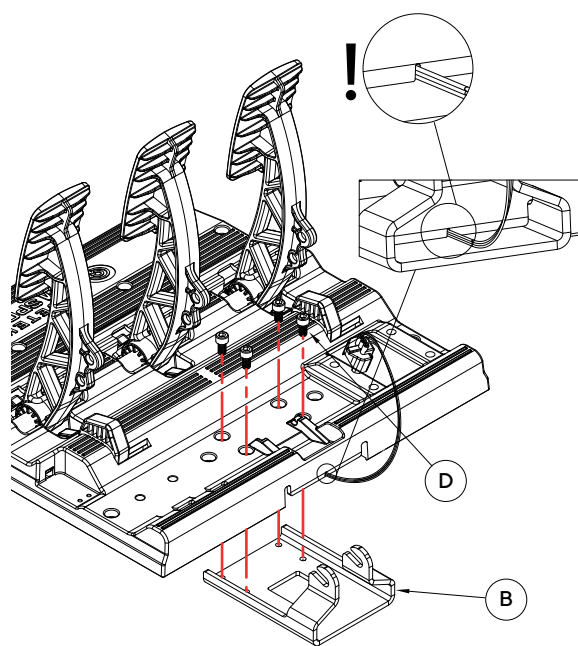

4

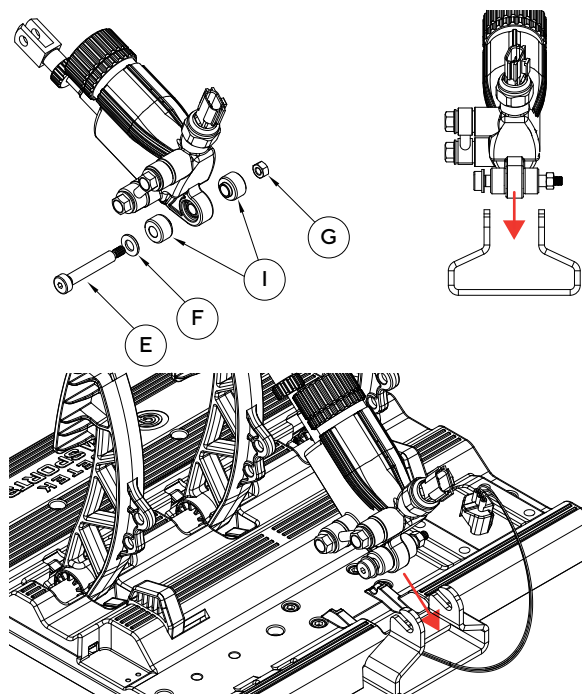

5

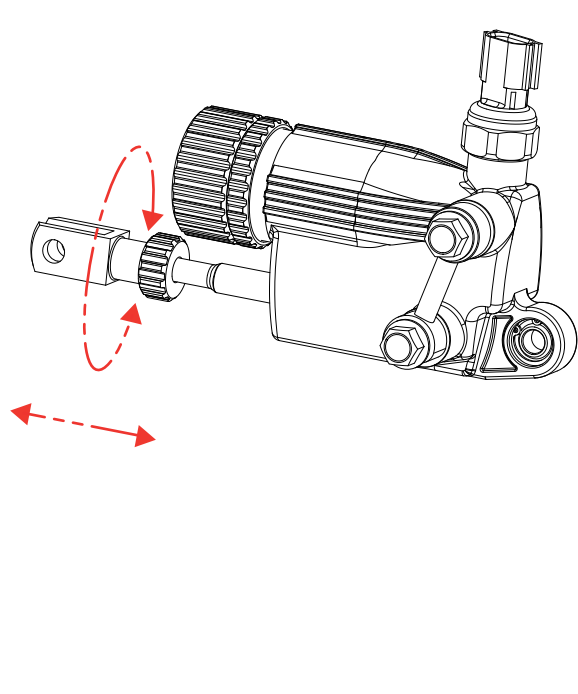

6

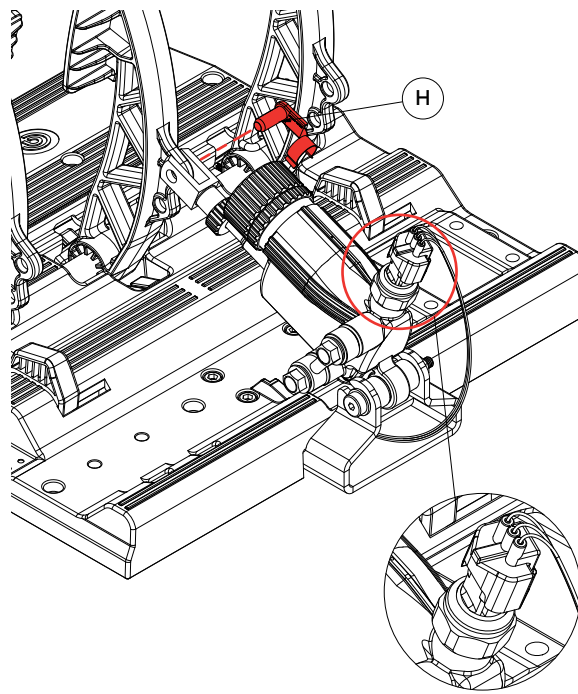



7

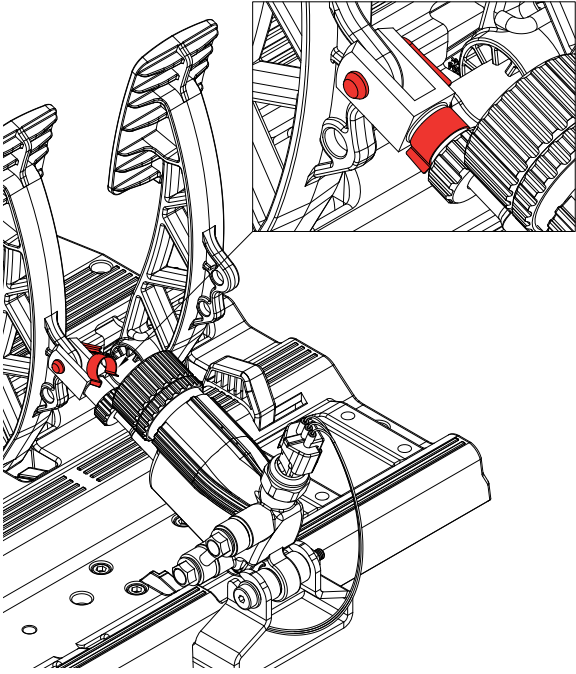

5. Push the pedal arm forwards aligning it with the pin hole of the rod clevis, and push the rod clevis lock back in its place

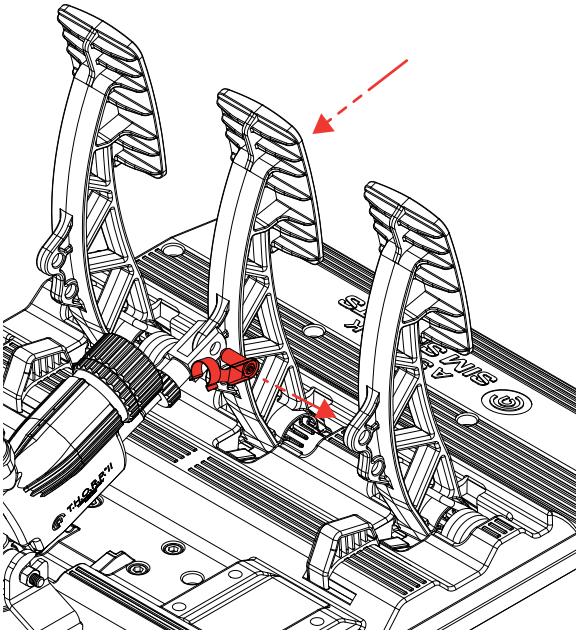

6. Recalibrate the brake in RaceHub™.

5. Attach the elastomer guide on the new elastomer.

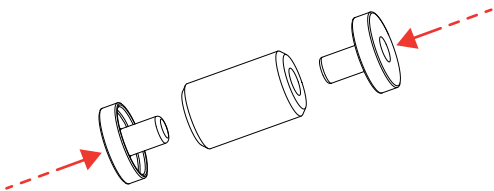

6. Place the elastomer with elastomer guides attached all inside of the brake cylinder.

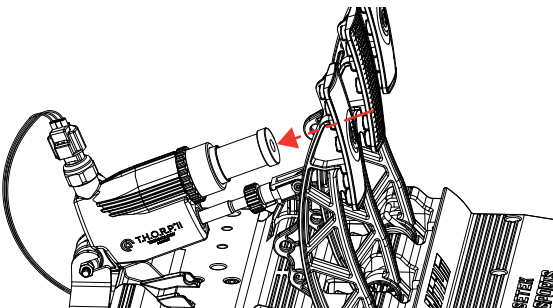

## Settings: Preload Adjustment

1. Turning clockwise, loosen the thumbnut locking the pedal in place. It is the one closest to the pedal arm.

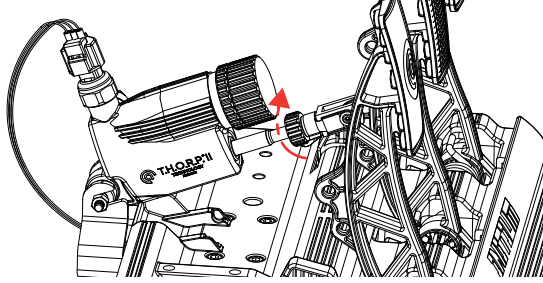

2. Push the Rod clevis lock pin upward to detach the pedal arm from the rod clevis and pull the pin outwards.

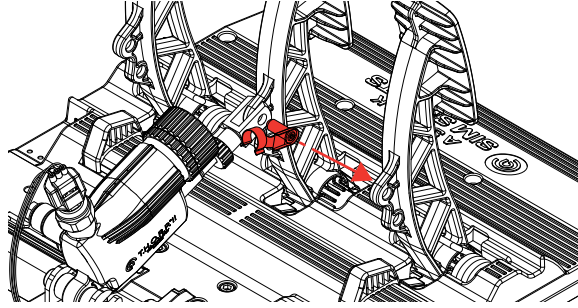

3. Swing the pedal rod out of the way.

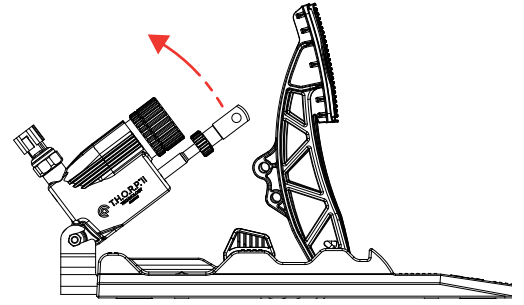

4. Turning the clevis rod:
  - a. Counter-clockwise will decrease the length of the brake rod, giving you some 'play' before you actively engage the brake.
  - b. Clockwise will actively engage the brake sooner.

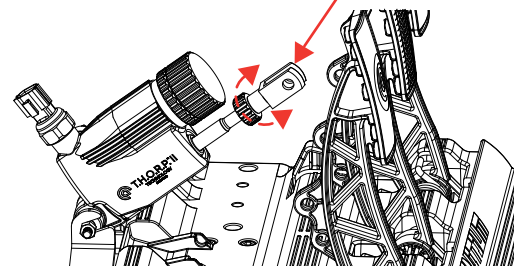

## Settings: Swapping Elastomers

1. To swap the elastomers, loosen the orange lock nut on the outermost part of the brake cylinder by turning it clockwise.

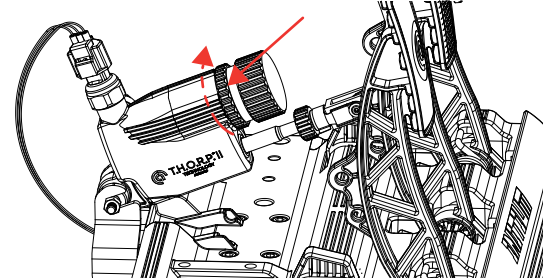

2. Turn the brake cylinder cap counter-clockwise until it comes out of the shaft.

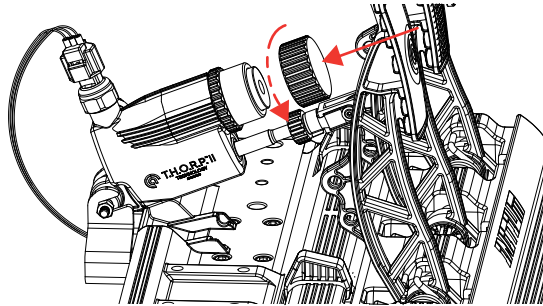

3. Press on the brake pedal with your hand until the elastomer with elastomer guide is visible. You can now take the elastomer with the elastomer guide out with ease.

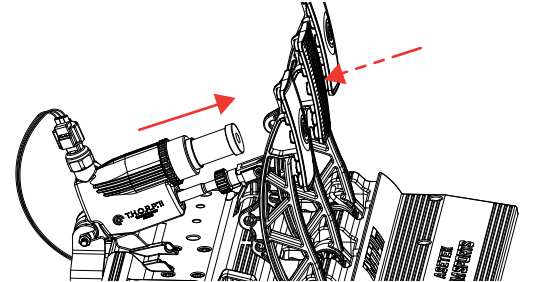

4. Take of the elastomer guide from both the top and bottom of the elastomer.

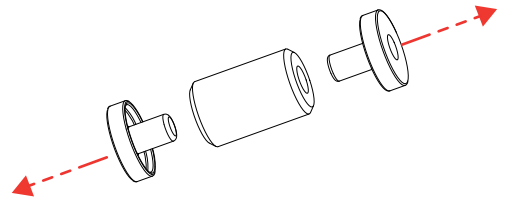

## De-commissioning & Sustainability:

At Asetek we are fiercely committed to making the world a sustainable place. [www.asetek.com/company/sustainability](http://www.asetek.com/company/sustainability)

### Packaging

All packaging is made of paper and cardboard. All our cardboard and paper products are labeled with the FSC mark, ensuring maximum reusability and that the forests are sustainably forested. Furthermore, we regularly check our vendors to make sure they are upholding their commitments.

About FSC: [www.fsc.org/en/fsc-labels](http://www.fsc.org/en/fsc-labels)

If you need to dispose of your packaging, please use the appropriate paper waste stream in your country, to dispose of the packaging. Naturally, we hope you want to keep it around – we are quite proud of it.

### Product

If you feel uncertain about how to recycle any Asetek SimSports® or Asetek Racing™ product, we suggest getting in touch with our dedicated customer support team, who will happily help you.

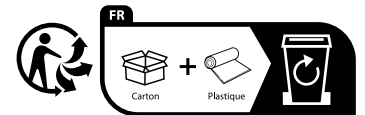

Points de collecte sur [www.quefaireadesdechets.fr](http://www.quefaireadesdechets.fr)  
Privilégiez la réparation ou le don de votre appareil!